



# GLASS ACCESSORIES



## Advanced Glass Co., Ltd.

**Add:** 302#, Duoxi Centre, Lunjiao, Shunde,  
Foshan, Guangdong, China (528308)

**Tel:** +86-757-26151870 **Fax:** +86-757-26151875

**Email:** [sales@advancedglass.cn](mailto:sales@advancedglass.cn); [beirut@advancedglass.cn](mailto:beirut@advancedglass.cn)

**Website:** [www.advancedglass.cn](http://www.advancedglass.cn)



# Contents

FLOOR HINGE SERIES ----- 01/15

PATCH FITTING SERIES ----- 16/35

GLASS GATE LOCK SERIES ----- 36/40

HANDLE SERIES ----- 41/49

SHOWER HINGE SERIES ----- 50/56

GLASS CONNECTOR SERIES ----- 57/65

BATHROOM ACCESSORY SERIES ----- 66/69

PVC SEALING STRIP SERIES ----- 70/71

SLIDING WHEELS SERIES ----- 72/81

HANGING WHEELS SERIES ----- 82

BALUSTRADE SERIES ----- 83/86

# FLOOR HINGE SERIES



# FT-08



# FT-18



## FT-18O



## FT-18T



### The Function Instruction

#### Strong quality and much easier installation

No drilling on the ground  
Much more economic and faster than traditional floor hinge  
Base can adjust  $\pm 5\text{mm}$  in the left-right & front-back direction  
Angle of rotation:  $\pm 4^\circ$

Please refer to the standard instruction which packed inside with the product.  
Stainless steel with satin finish (can be ordered in according to customer's requirement)

### Technological data

Door size	800x2000mm
Door weight	45-65kg
Dimension of product	72x72x85mm
Max opening angle	360°
Hold open in single side	90° /180°
Closing speed adjustment	X
Buffer space adjustment	X
Explosion-proof	√
Hold open	√

Available Not available

### Size

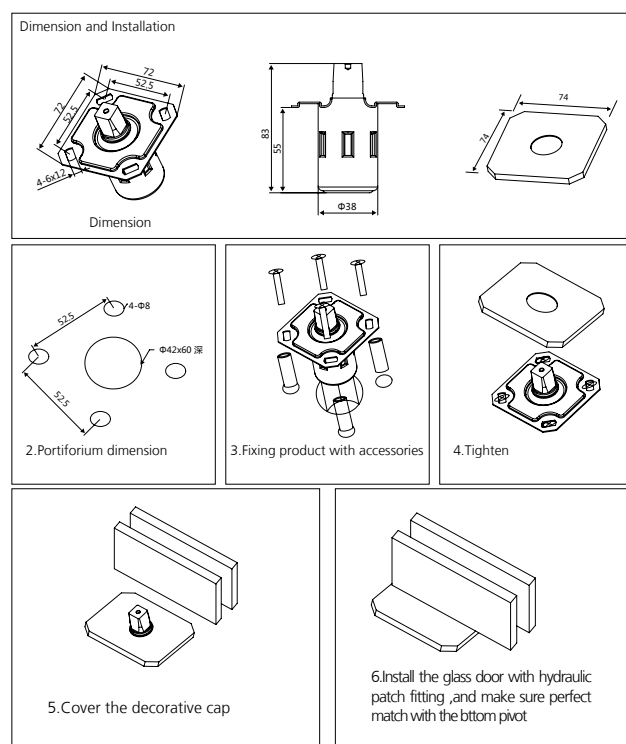

### The Function Instruction

1. Select the high quality steel for transmission parts. The service life of Italy oil seal is over half a million times
2. General designed is suitable for opening doors with left/right hand and single/double opening.
3. Filled with high quality anti-icing hydraulic oil, ensuring that closing speed won't be affected at minus 20 degrees.
4. The design no need drill hole on the floor, making installation easier.
5. Applicable in all public glass doors.

### Technological data

Door weight	60kg
Dimension of appearance	195x78x44mm
Suitable for door size	800x2000mm
Location degree	90° 180° 370° 360°
Double action door	<input checked="" type="checkbox"/>
2 Section speed adjustment valve	<input checked="" type="checkbox"/>

The products have passed national QB/T2697-2005 standard

### Size

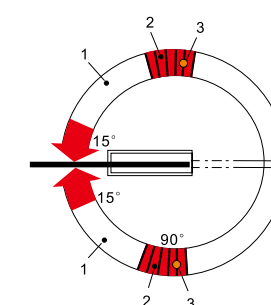
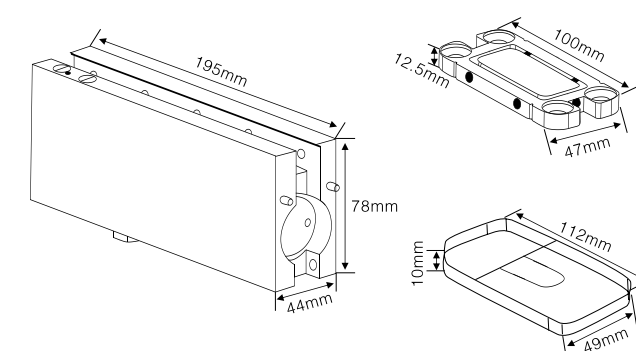

1. Two-stFte closing speed control valves are adjustable from 175°-15° and from 15°-0°, closing process control by hydraulic oil
2. Backcheck function (occurred in about 70 degree)
3. Door leaf hold open function set in 90° -150°

## FT-50



### The Function Instruction

1. Select the high quality steel for transmission parts. The service life of Italy oil seal is over half a million times.
2. General designed is suitable for opening doors with left/right hand and single/double opening.
3. Filled with high quality anti-icing hydraulic oil, ensuring that closing speed won't be affected at minus 20 degrees.
4. The design no need drill hole on the floor, making installation easier.
5. Applicable in all public glass doors.

### Technological data

Door weight	85kg
Dimension of appearance	250x110x47mm
Suitable for door size	800x2000mm
Location degree	90°
Double action door	<input checked="" type="checkbox"/>
2 Section speed adjustment valve	<input checked="" type="checkbox"/>

The products have passed national QB/T2697-2005 standard

### Size

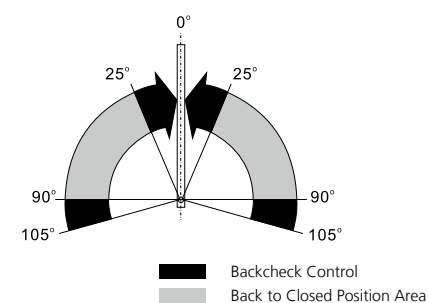
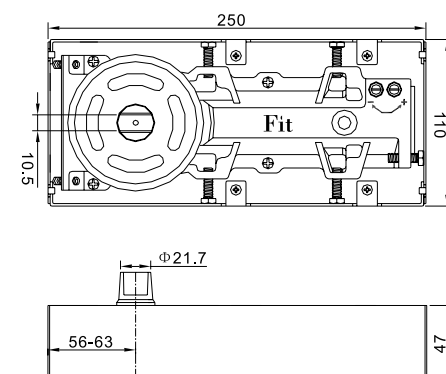

## FT-60



### The Function Instruction

1. Select the high quality steel for transmission parts. The service life of Italy oil seal is over half a million times.
2. General designed is suitable for opening doors with left/right hand and single/double opening.
3. Filled with high quality anti-icing hydraulic oil, ensuring that closing speed won't be affected at minus 20 degrees.
4. The design no need drill hole on the floor, making installation easier.
5. Applicable in all public glass doors.

### Technological data

Door weight	95kg
Dimension of appearance	251x110x51mm
Suitable for door size	1000x2100mm
Location degree	90°
Double action door	<input checked="" type="checkbox"/>
2 Section speed adjustment valve	<input checked="" type="checkbox"/>

The products have passed national QB/T2697-2005 standard

### Size

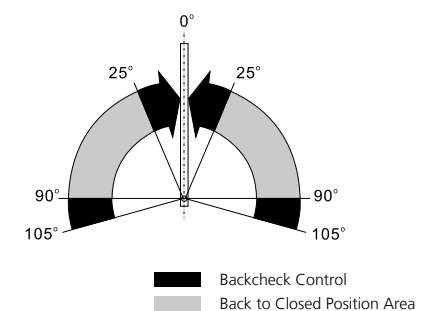
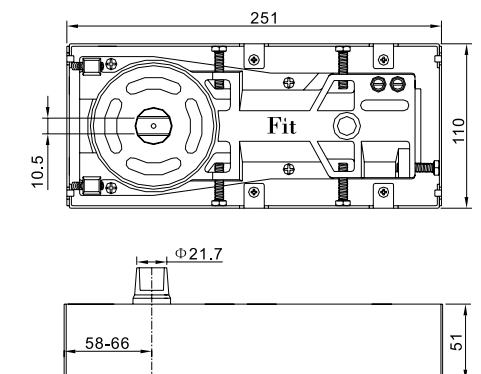



## FT-65



### The Function Instruction

1. Select the high quality steel for transmission parts. The service life of Italy oil seal is over half a million times.
2. General designed is suitable for opening doors with left/right hand and single/double opening.
3. Filled with high quality anti-icing hydraulic oil, ensuring that closing speed won't be affected at minus 20 degrees.
4. The design no need drill hole on the floor, making installation easier.
5. Applicable in all public glass doors.

### Technological data

Door weight	105kg
Dimension of appearance	275x108x41mm
Suitable for door size	1000x2100mm
Location degree	90°
Double action door	<input checked="" type="checkbox"/>
2 Section speed adjustment valve	<input checked="" type="checkbox"/>

The products have passed national QB/T2697-2005 standard

### Size

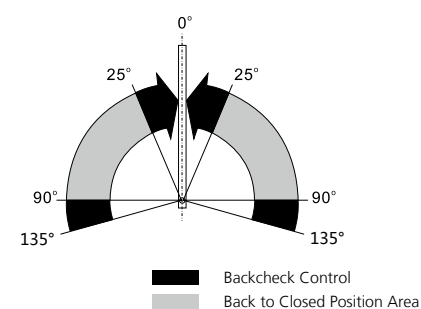
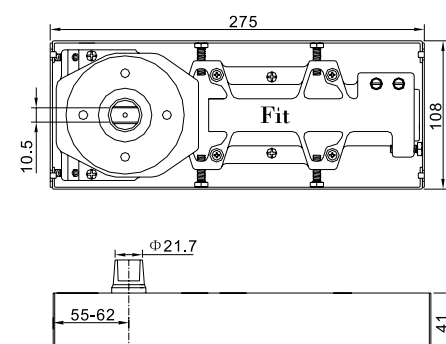

## FT-84



### The Function Instruction

1. Select the high quality steel for transmission parts. The service life of Italy oil seal is over half a million times.
2. General designed is suitable for opening doors with left/right hand and single/double opening.
3. Filled with high quality anti-icing hydraulic oil, ensuring that closing speed won't be affected at minus 20 degrees.
4. The design no need drill hole on the floor, making installation easier.
5. Applicable in all public glass doors.

### Technological data

Door weight	120kg
Dimension of appearance	305x108x41mm
Suitable for door size	1000x2600mm
Location degree	90°
Double action door	<input checked="" type="checkbox"/>
2 Section speed adjustment valve	<input checked="" type="checkbox"/>

The products have passed national QB/T2697-2005 standard

### Size

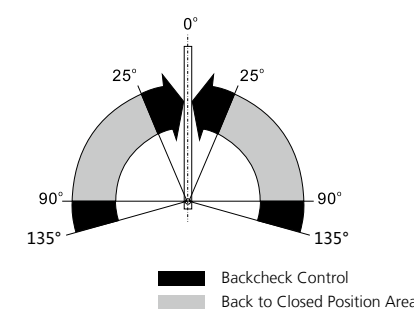
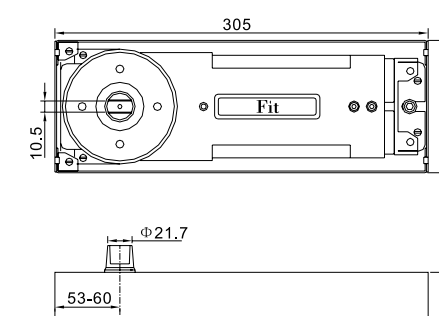

## FT-75

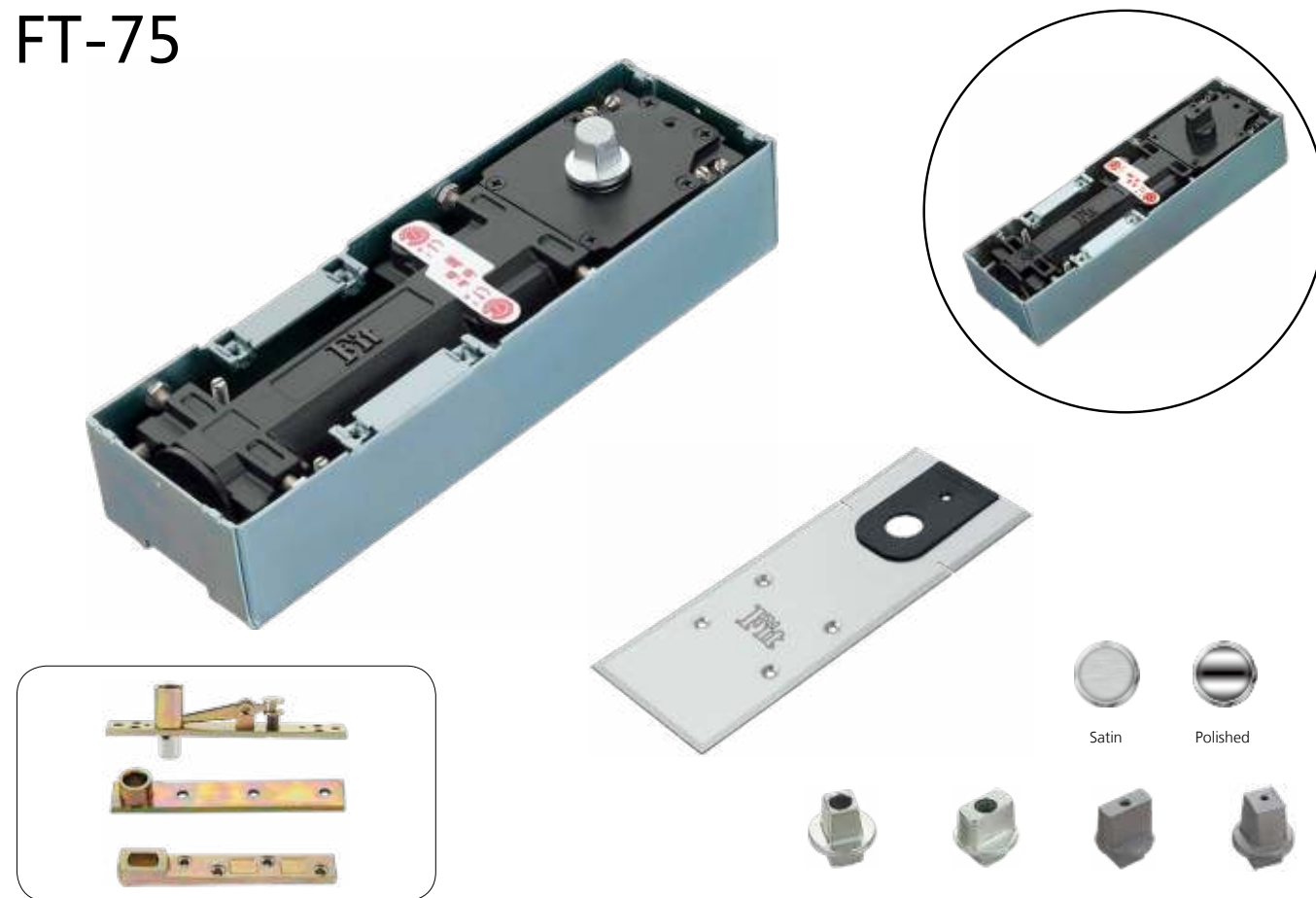

### The Function Instruction

1. Select the high quality steel for transmission parts. The service life of Italy oil seal is over half a million times.
2. General designed is suitable for opening doors with left/right hand and single/double opening.
3. Filled with high quality anti-icing hydraulic oil, ensuring that closing speed won't be affected at minus 20 degrees.
4. The design no need drill hole on the floor, making installation easier.
5. Applicable in all public glass doors.

### Size

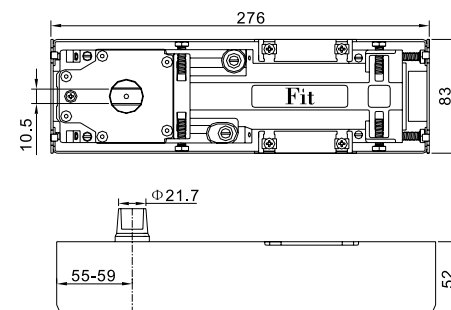

### Technological data

Door weight	90kg
Dimension of appearance	276x83x52mm
Suitable for door size	1000x2100mm
Location degree	90° 180° 270° 380°
Double action door	<input checked="" type="checkbox"/>
2 Section speed adjustment valve	<input checked="" type="checkbox"/>

The products have passed national QB/T2697-2005 standard

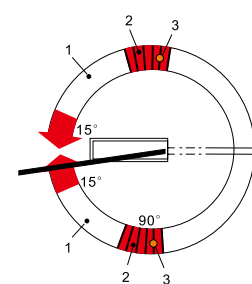

1. Two-stFte closing speed control valves are adjustable from 175°-15° and from 15°-0°, closing process control by hydraulic oil
2. Backcheck function (occurred in about 70 degree)
3. Door leaf hold open function set in 90° -150°

## FT-8100



### The Function Instruction

1. Select the high quality steel for transmission parts. The service life of Italy oil seal is over half a million times.
2. General designed is suitable for opening doors with left/right hand and single/double opening.
3. Filled with high quality anti-icing hydraulic oil, ensuring that closing speed won't be affected at minus 20 degrees.
4. The design no need drill hole on the floor, making installation easier.
5. Applicable in all public glass doors.

### Size

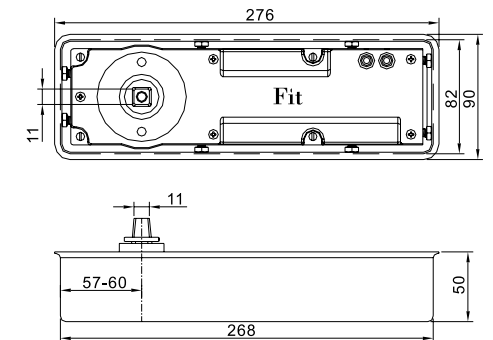

### Technological data

Door weight	100kg
Dimension of appearance	276x90x50mm
Suitable for door size	1000x2100mm
Location degree	90° 180° 270° 360°
Double action door	<input checked="" type="checkbox"/>
2 Section speed adjustment valve	<input checked="" type="checkbox"/>

The products have passed national QB/T2697-2005 standard

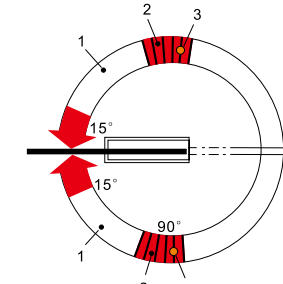

1. Two-stFte closing speed control valves are adjustable from 175°-15° and from 15°-0°, closing process control by hydraulic oil
2. Backcheck function (occurred in about 70 degree)
3. Door leaf hold open function set in 90° -150°

## FT-7315



### The Function Instruction

1. Select the high quality steel for transmission parts. The service life of Italy oil seal is over half a million times.
2. General designed is suitable for opening doors with left/right hand and single/double opening.
3. Filled with high quality anti-icing hydraulic oil, ensuring that closing speed won't be affected at minus 20 degrees.
4. The design no need drill hole on the floor, making installation easier.
5. Applicable in all public glass doors.

### Technological data

Door weight	75kg
Dimension of appearance	225x105x56mm
Suitable for door size	800x2000mm
Location degree	90°
Double action door	<input checked="" type="checkbox"/>
2 Section speed adjustment valve	<input checked="" type="checkbox"/>

The products have passed national QB/T2697-2005 standard

### Size

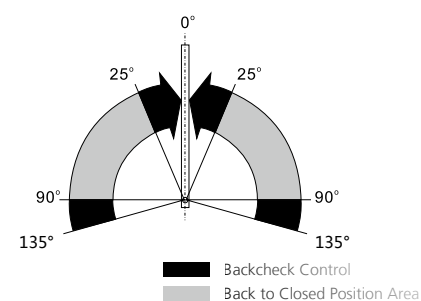
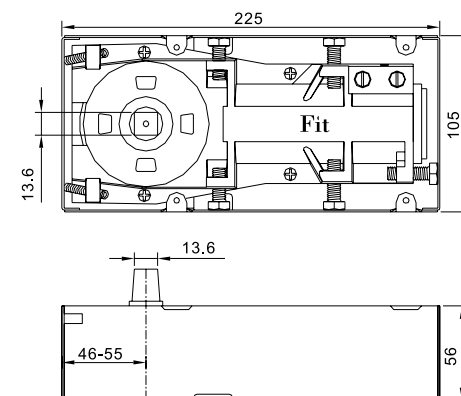

## FT-7335



### The Function Instruction

1. Select the high quality steel for transmission parts. The service life of Italy oil seal is over half a million times.
2. General designed is suitable for opening doors with left/right hand and single/double opening.
3. Filled with high quality anti-icing hydraulic oil, ensuring that closing speed won't be affected at minus 20 degrees.
4. The design no need drill hole on the floor, making installation easier.
5. Applicable in all public glass doors.

### Technological data

Door weight	110kg
Dimension of appearance	278x130x65mm
Suitable for door size	1000x2200mm
Location degree	90°
Double action door	<input checked="" type="checkbox"/>
2 Section speed adjustment valve	<input checked="" type="checkbox"/>

The products have passed national QB/T2697-2005 standard

### Size

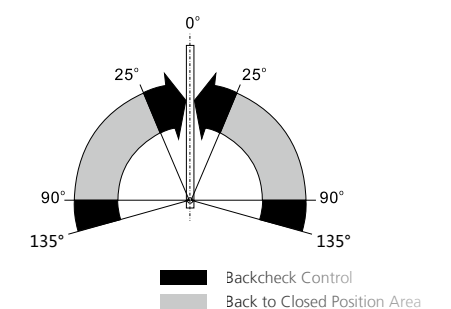
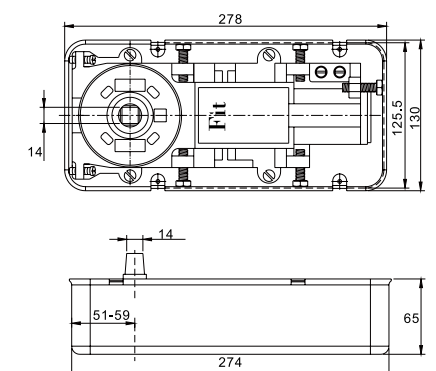



# FT-730



## The Function Instruction

- 1.Select the high quality steel for transmission parts.The service life of Italy oil seal is over half a million times
- 2.General designed is suitable for opening doors with leFT/right hand and single/ double opening.
- 3.Filled with high quality anti-icing hydraulic oil,ensuring that closing speed won't be affected at minus 20 degrees.
- 4.The design no need drill hole on the floor, making installation easier.
- 5.Applicable in all public glass doors.

## Technological data

Door weight	120kg
Dimension of appearance	283x131x70mm
Suitable for door size	1000x2300mm
Location degree	90° 135°
Double action door	<input checked="" type="checkbox"/>
2 Section speed adjustment valve	<input checked="" type="checkbox"/>

The products have passed national QB/T2697-2005 standard

## Size

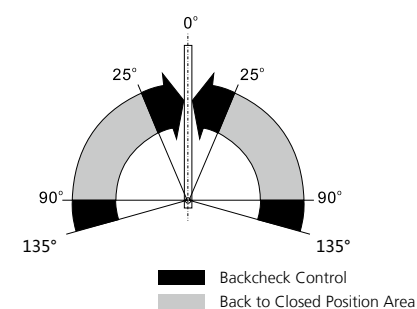
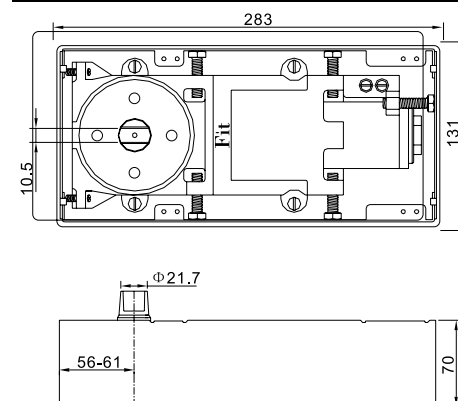

# FT-760



## The Function Instruction

- 1.Select the high quality steel for transmission parts.The service life of Italy oil seal is over half a million times
- 2.General designed is suitable for opening doors with leFT/right hand and single/ double opening.
- 3.Filled with high quality anti-icing hydraulic oil,ensuring that closing speed won't be affected at minus 20 degrees.
- 4.The design no need drill hole on the floor, making installation easier.
- 5.Applicable in all public glass doors.

## Technological data

Door weight	90kg
Dimension of appearance	272x123x68.5mm
Suitable for door size	1000x2000mm
Location degree	90°
Double action door	<input checked="" type="checkbox"/>
2 Section speed adjustment valve	<input checked="" type="checkbox"/>

QB/T2697-2005 The products have passed national QB/T2697-2005 standard

## Size

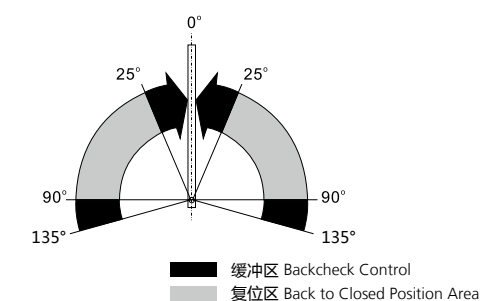
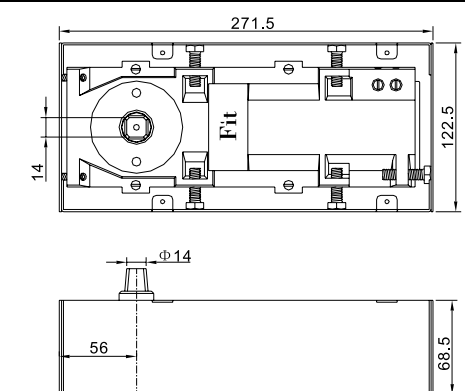



# FT-1400B



## The Function Instruction

- 1.Select the high quality steel for transmission parts.The service life of Italy oil seal is over half a million times
- 2.General designed is suitable for opening doors with leFT/right hand and single/ double opening.
- 3.Filled with high quality anti-icing hydraulic oil,ensuring that closing speed won't be affected at minus 20 degrees.
- 4.The design no need drill hole on the floor, making installation easier.
- 5.Applicable in all public glass doors.

## Technological data

Door weight	120kg
Dimension of appearance	283x130x65mm
Suitable for door size	1000x2300mm
Location degree	90°
Double action door	<input checked="" type="checkbox"/>
2 Section speed adjustment valve	<input checked="" type="checkbox"/>

QB/T2697-2005 The products have passed national QB/T2697-2005 standard

## Size

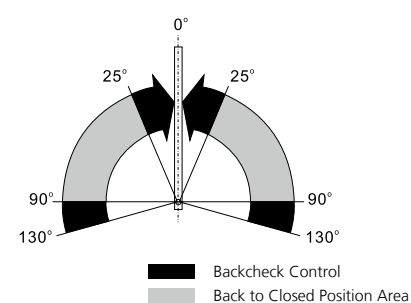
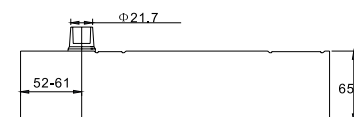
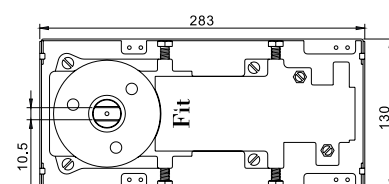

# FT-205A

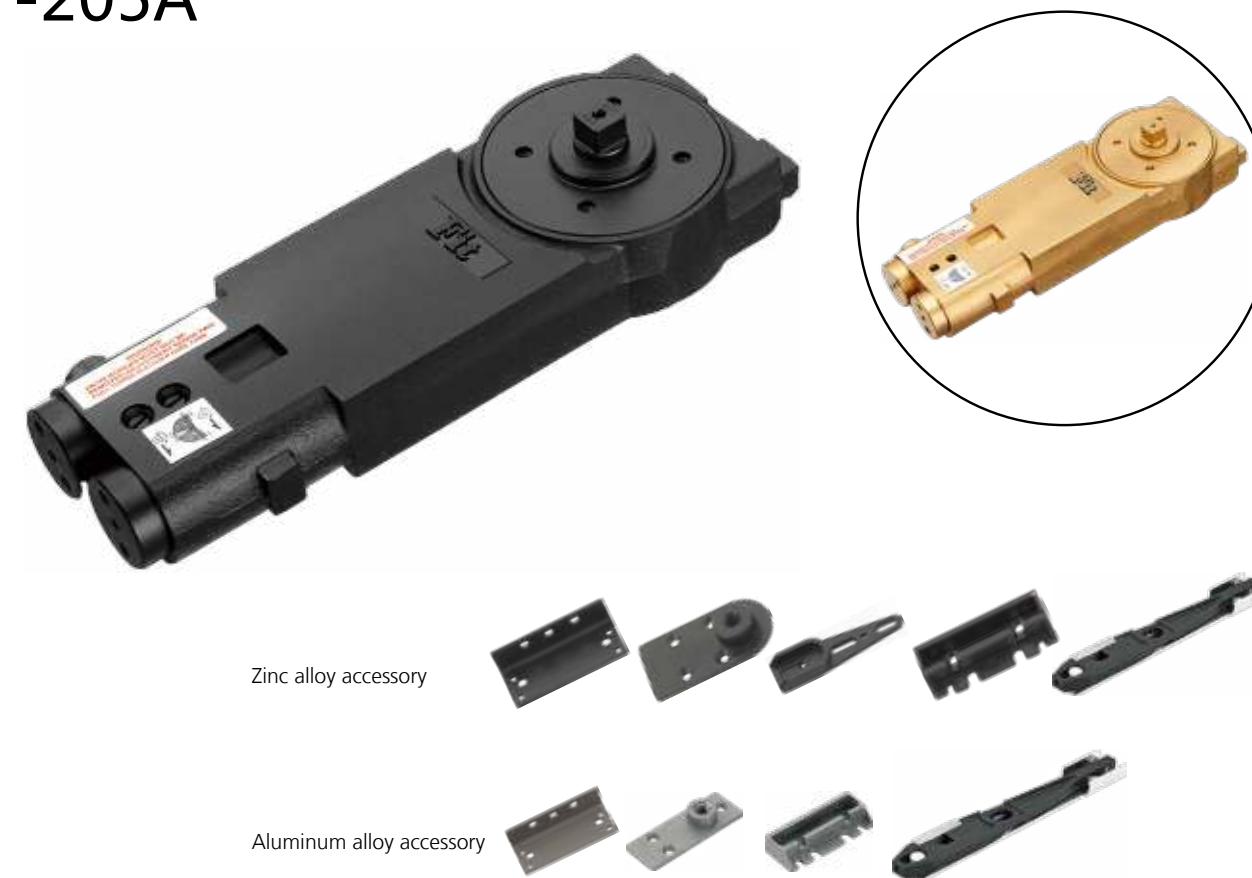

## The Function Instruction

- 1.Select the high quality steel for transmission parts.The service life of Italy oil seal is over half a million times
- 2.General designed is suitable for opening doors with leFT/right hand and single/ double opening.
- 3.Filled with high quality anti-icing hydraulic oil,ensuring that closing speed won't be affected at minus 20 degrees.
- 4.The design no need drill hole on the floor, making installation easier.
- 5.Applicable in all public glass doors.

## Technological data

Door weight	120kg
Dimension of appearance	263x123x50mm
Suitable for door size	1000x2300mm
Location degree	90°
Double action door	<input checked="" type="checkbox"/>
2 Section speed adjustment valve	<input checked="" type="checkbox"/>

QB/T2697-2005 The products have passed national QB/T2697-2005 standard

## Size

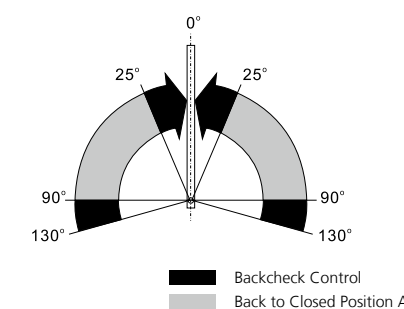
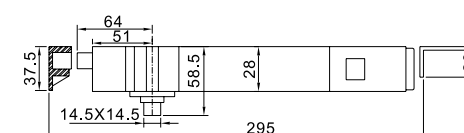
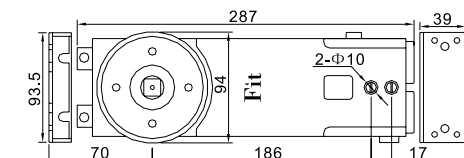

# PATCH FITTING SERIES



**FT233**  
Bottom pivot  
Material:stainless steel

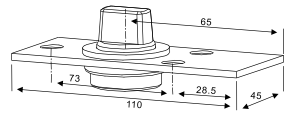

**FT233B**  
Bottom pivot  
Material:stainless steel

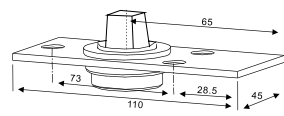

**FT333**  
Top pivot  
Material:stainless steel

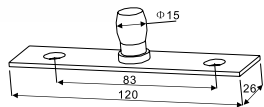

**FT333B**  
Top pivot  
Material:stainless steel

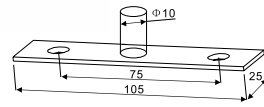

**FT333C**  
Top pivot  
Material:stainless steel

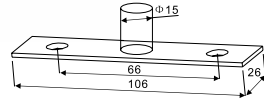

**FT-ACC01**  
( Fittings for floor hinge)  
Material :Casting Iron

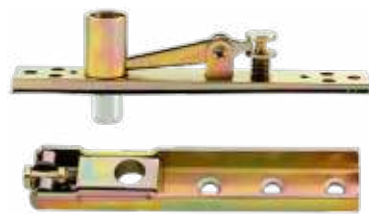

**FT-ACC02**  
(Fittings for floor hinge)  
Material :Casting Iron



**FT-ACC03**  
(Fittings for floor hinge)  
Material :Casting Iron



**FT-ACC04**  
(Fittings for floor hinge)  
Material :Casting Iron



**FT-ACC05**  
(Fittings for floor hinge)  
Material :Casting Iron



**FT-ACC06**  
(Fittings for floor hinge)  
Material :Casting Iron



## SQUARE PATCH FITTING MODELS

Material for customized:



Polish



Stain



Customized color

Attention: for 8mm-12mm toughened glass

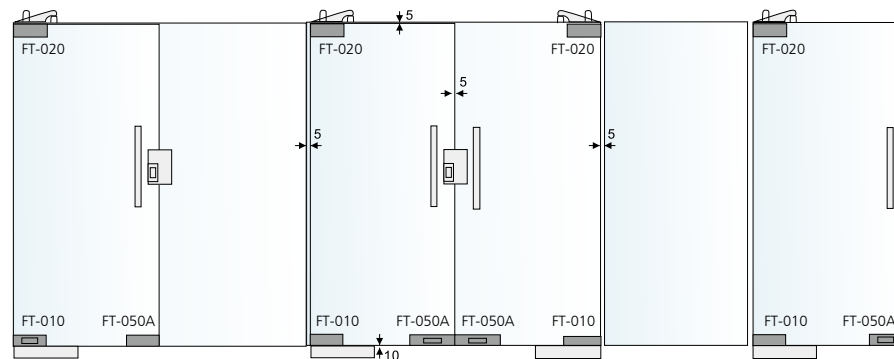

SQUARE PATCH FITTING MODELS

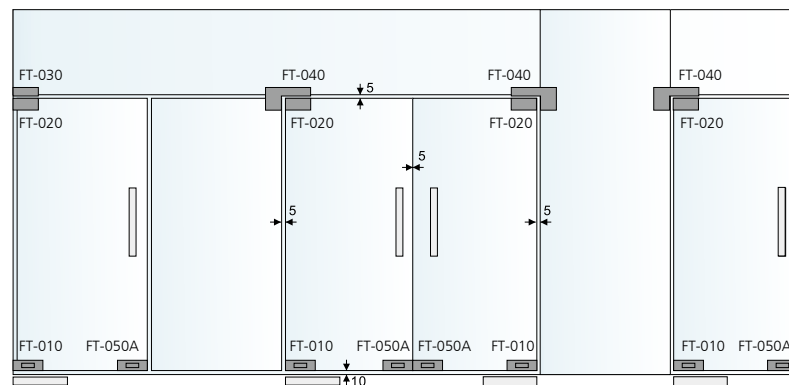
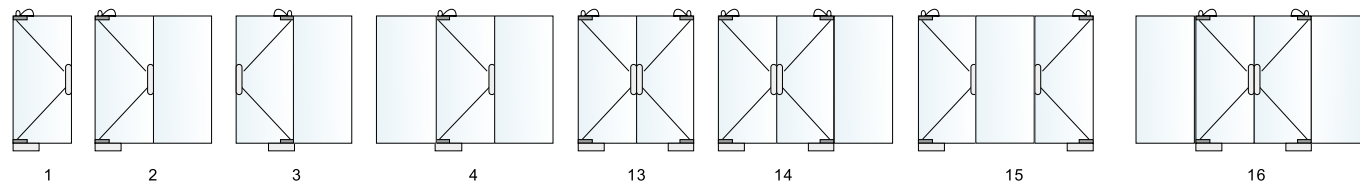

IRREGULAR PATCH FITTING MODELS

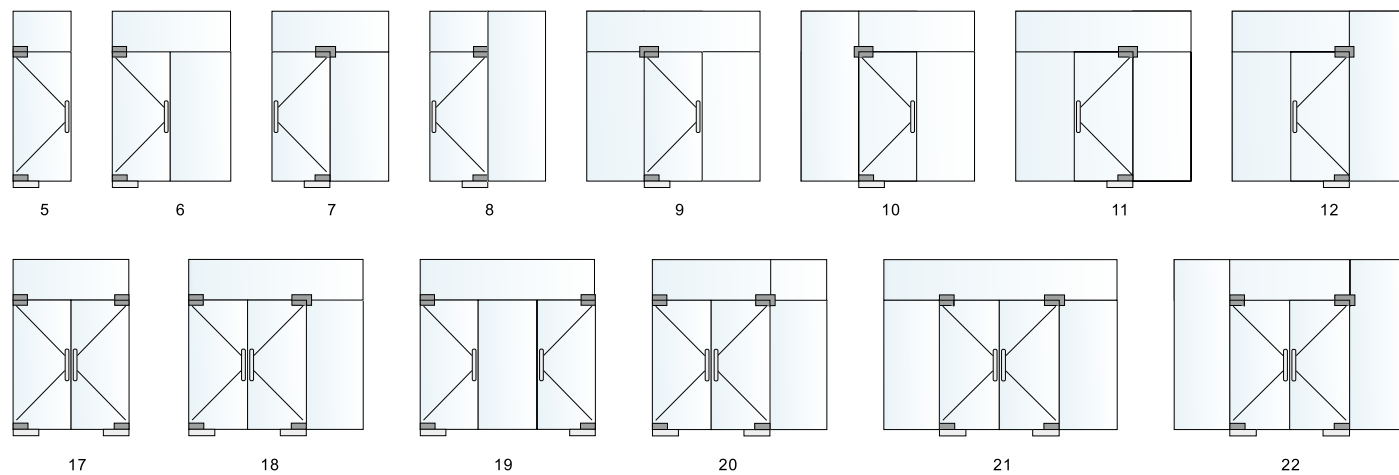

## INSTRUCTIONS

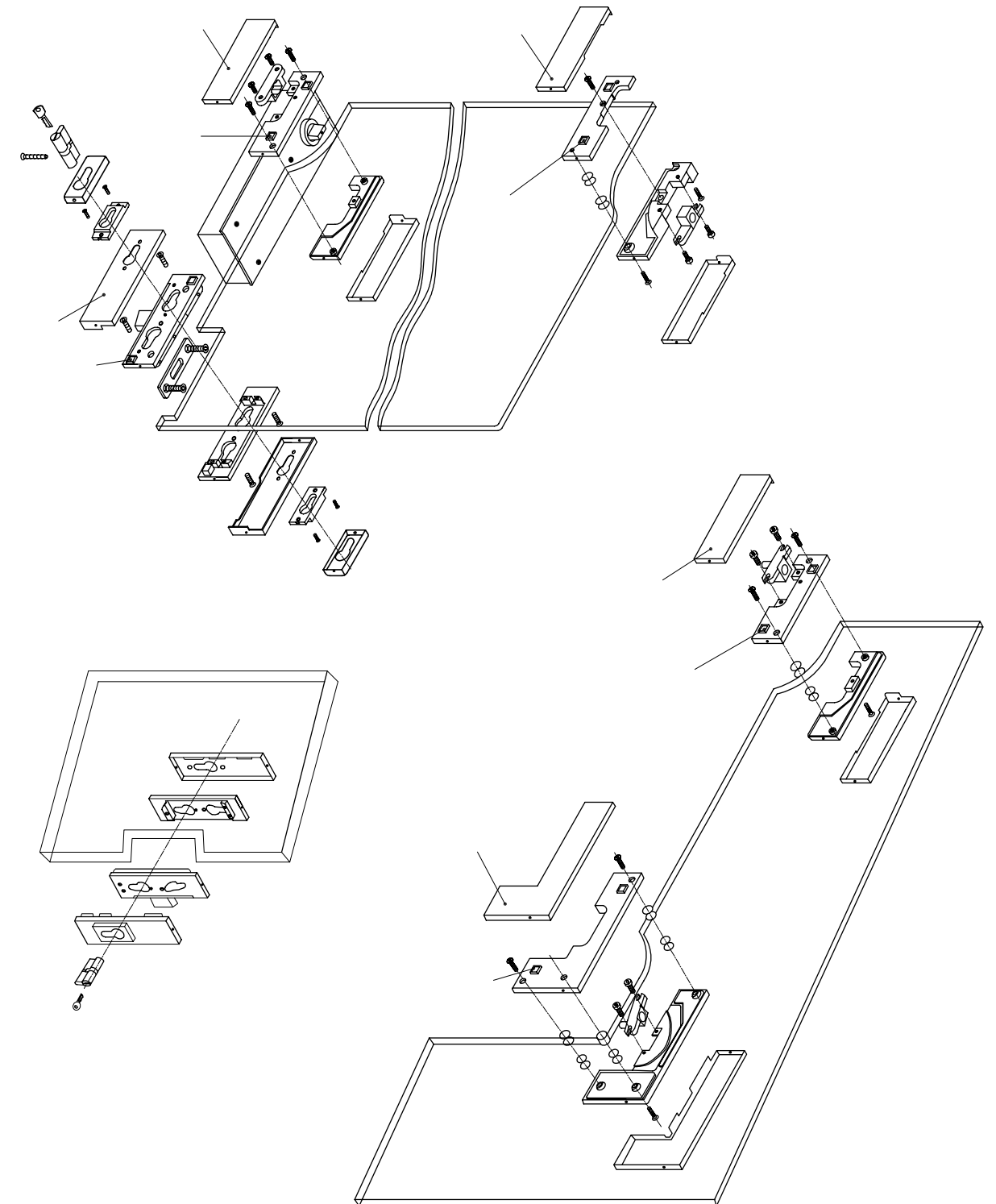





## NO.FT010 (Bottom patch)

1. Fit for glass thickness: 10mm 12mm
2. Material:  
Aluminum alloy;  
Zinc-alloy;  
Stainless steel cover plate
3. Finish of the cover plate:  
Satin stainless steel(SSS)  
Polished stainless steel(PSS)  
Titanium Plated(Ti)
4. Bottom patch available for Dorma, New star, MAB etc. floor hinge

Dimensions

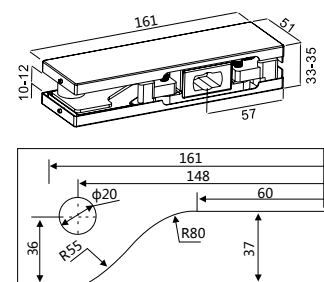

## NO.FT020 (Top patch)

1. Fit for glass thickness: 10mm 12mm
2. Material:  
Aluminum alloy;  
Zinc-alloy;  
Stainless steel cover plate
3. Finish of the cover plate:  
Satin stainless steel(SSS)  
Polished stainless steel(PSS)  
Titanium Plated(Ti)
4. Bottom patch available for Dorma, New star, MAB etc. floor hinge

Dimensions

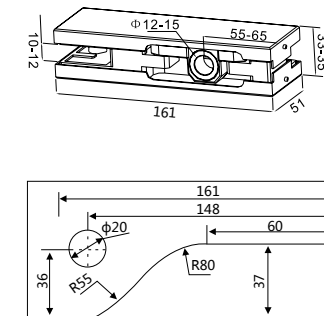

## NO.FT030 (Overpanel pivot patch)

1. Fit for glass thickness: 10mm 12mm
2. Material:  
Aluminum alloy;  
Zinc-alloy;  
Stainless steel cover plate
3. Finish of the cover plate:  
Satin stainless steel(SSS)  
Polished stainless steel(PSS)  
Titanium Plated(Ti)
4. Bottom patch available for Dorma, New star, MAB etc. floor hinge

Dimensions

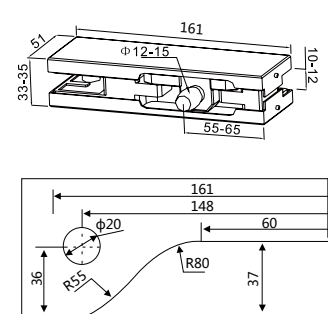

## NO.FT030S (Overpanel pivot patch with screw)

1. Fit for glass thickness: 10mm 12mm
2. Material:  
Aluminum alloy;  
Zinc-alloy;  
Stainless steel cover plate
3. Finish of the cover plate:  
Satin stainless steel(SSS)  
Polished stainless steel(PSS)  
Titanium Plated(Ti)

Dimensions

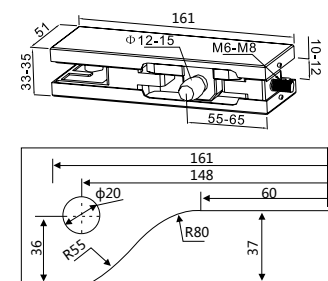

## NO.FT030P (Overpanel pivot patch with plate)

1. Fit for glass thickness: 10mm 12mm
2. Material:  
Aluminum alloy;  
Zinc-alloy;  
Stainless steel cover plate
3. Finish of the cover plate:  
Satin stainless steel(SSS)  
Polished stainless steel(PSS)  
Titanium Plated(Ti)

Dimensions

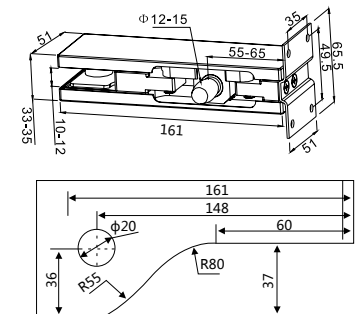

## NO.FT040 (Overpanel corner "L" patch)

1. Fit for glass thickness: 10mm 12mm
2. Material:  
Aluminum alloy;  
Zinc-alloy;  
Stainless steel cover plate
3. Finish of the cover plate:  
Satin stainless steel(SSS)  
Polished stainless steel(PSS)  
Titanium Plated(Ti)

Dimensions

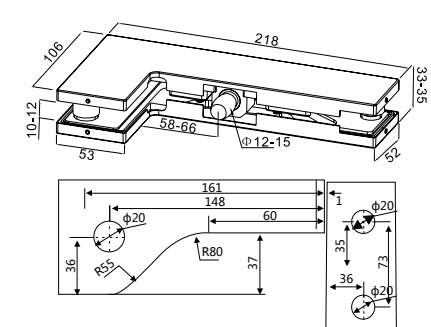

## NO.FT040B (Overpanel strike box "L" patch)

1. Fit for glass thickness: 10mm 12mm
2. Material:  
Aluminum alloy;  
Zinc-alloy;  
Stainless steel cover plate
3. Finish of the cover plate:  
Satin stainless steel(SSS)  
Polished stainless steel(PSS)  
Titanium Plated(Ti)

Dimensions

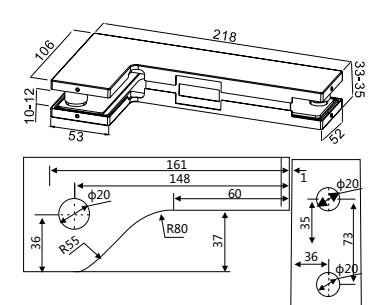

## NO.FT050A (Bottom lock)

1. Fit for glass thickness: 10mm 12mm
2. Material:  
Aluminum alloy;  
Zinc-alloy;  
Stainless steel cover plate
3. Finish of the cover plate:  
Satin stainless steel(SSS)  
Polished stainless steel(PSS)  
Titanium Plated(Ti)

Dimensions

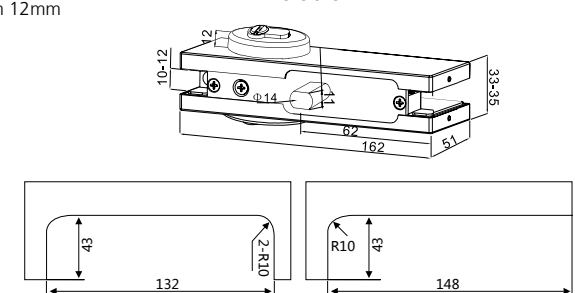



## NO.FT050B ( Center lock )

- 1.Fit for glass thickness:10mm 12mm
- 2.Material:  
Aluminum alloy;  
Zinc-alloy;  
Stainless steel cover plate
- 3.Finish of the cover plate:  
Satin stainless steel(SSS)  
Polished stainless steel(PSS)  
Titanium Plated(Ti)

Dimensions

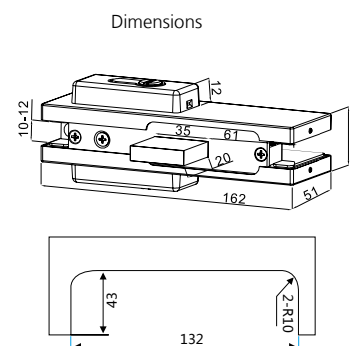

## NO.FT050C ( Bottom lock )

- 1.Fit for glass thickness:10mm 12mm
- 2.Material:  
Aluminum alloy;  
Zinc alloy;  
Stainless steel cover plate
- 3.Finish of the cover plate:  
Satin stainless steel(SSS)  
Polished stainless steel(PSS)  
Titanium Plated(Ti)

Dimensions

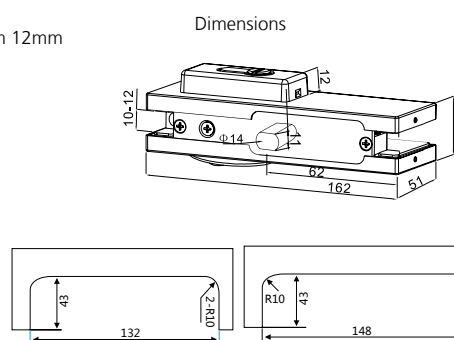

## NO.FT050D ( Center lock )

- 1.Fit for glass thickness:10mm 12mm
- 2.Material:  
Aluminum alloy;  
Zinc alloy;  
Stainless steel cover plate
- 3.Finish of the cover plate:  
Satin stainless steel(SSS)  
Polished stainless steel(PSS)  
Titanium Plated(Ti)

Dimensions

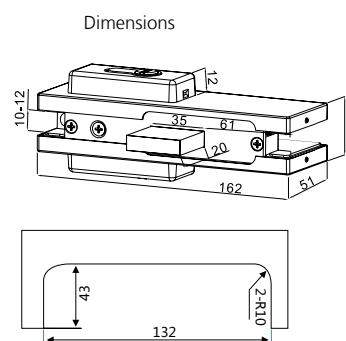

## NO.FT050K (Strike box)

- 1.Fit for glass thickness:10mm 12mm
- 2.Material:  
Aluminum alloy;  
Zinc-alloy;  
Stainless steel cover plate
- 3.Finish of the cover plate:  
Satin stainless steel(SSS)  
Polished stainless steel(PSS)  
Titanium Plated(Ti)

Dimensions

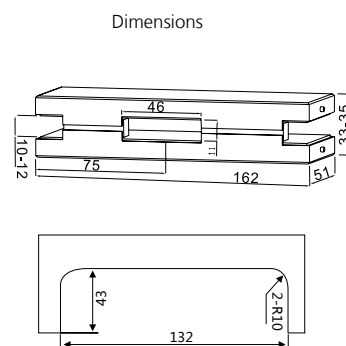

## NO.FT3010 (Bottom patch)

- 1.Fit for glass thickness:10mm 12mm
- 2.Material:  
Aluminum alloy;  
Stainless steel cover plate
- 3.Finish of the cover plate:  
Satin stainless steel(SSS)  
Polished stainless steel(PSS)  
Titanium Plated(Ti)
- 4.Bottom patch available for Dorma, New star, MAB etc. floor hinge

Dimensions

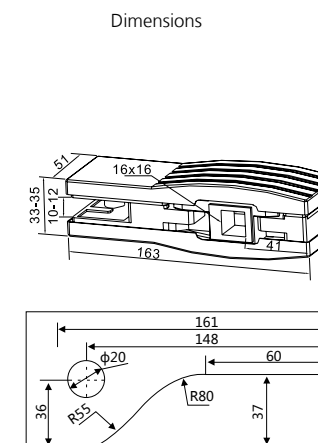

## NO.FT3020 (Top patch)

- 1.Fit for glass thickness:10mm 12mm
- 2.Material:  
Aluminum alloy;  
Stainless steel cover plate
- 3.Finish of the cover plate:  
Satin stainless steel(SSS)  
Polished stainless steel(PSS)  
Titanium Plated(Ti)
- 4.Top patch available for Dorma, New star, MAB etc. floor hinge

Dimensions

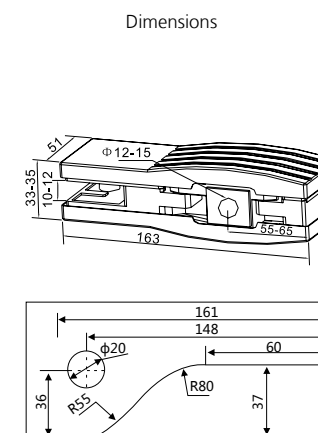

## NO.FT3030 (Overpanel pivot patch)

- 1.Fit for glass thickness:10mm 12mm
- 2.Material:  
Aluminum alloy;  
Stainless steel cover plate
- 3.Finish of the cover plate:  
Satin stainless steel(SSS)  
Polished stainless steel(PSS)  
Titanium Plated(Ti)

Dimensions

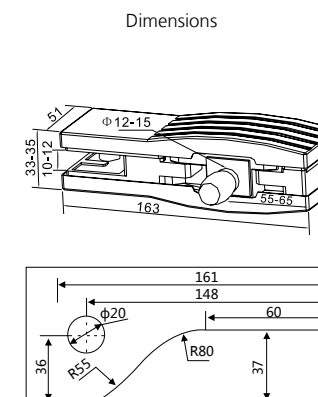

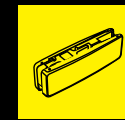

**NO.FT3030S** (Overpanel pivot patch with screw)

## Dimensions

1. Fit for glass thickness: 10mm 12mm
2. Material:
  - Aluminum alloy;
  - Stainless steel cover plate
3. Finish of the cover plate:
  - Satin stainless steel(SSS)
  - Polished stainless steel(PSS)
  - Titanium Plated(Ti)

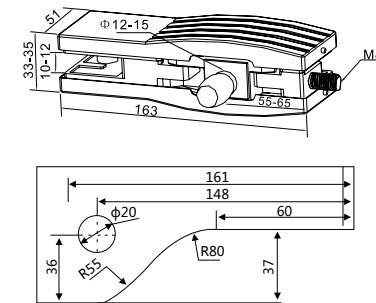

**NO.FT3040B** (Overpanel strike box "L" patch)

## Dimensions

1. Fit for glass thickness: 10mm 12mm
2. Material:
  - Aluminum alloy;
  - Stainless steel cover plate
3. Finish of the cover plate:
  - Satin stainless steel(SSS)
  - Polished stainless steel(PSS)
  - Titanium Plated(Ti)

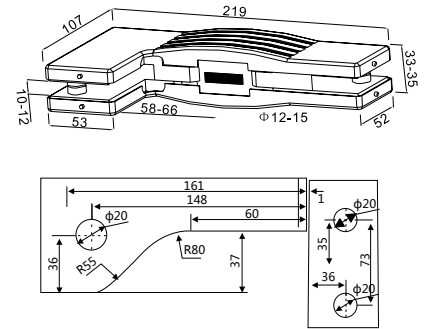

**NO.FT3030P** (Overpanel pivot patch with plate)

## Dimensions

1. Fit for glass thickness: 10mm 12mm
2. Material:
  - Aluminum alloy;
  - Stainless steel cover plate
3. Finish of the cover plate:
  - Satin stainless steel(SSS)
  - Polished stainless steel(PSS)
  - Titanium Plated(Ti)

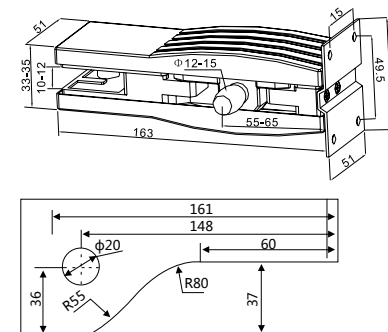

NO.FT3050 (Center lock)

## Dimensions

1. Fit for glass thickness: 10mm 12mm
2. Material:
  - Aluminum alloy;
  - Stainless steel cover plate
3. Finish of the cover plate:
  - Satin stainless steel(SSS)
  - Polished stainless steel(PSS)
  - Titanium Plated(Ti)

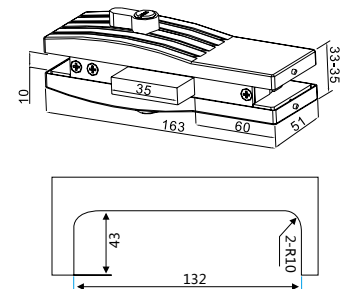

**NO.FT3040** (Overpanel corner "L" patch)

### Dimensions

1. Fit for glass thickness: 10mm 12mm
2. Material:
  - Aluminum alloy;
  - Stainless steel cover plate
3. Finish of the cover plate:
  - Satin stainless steel(SSS)
  - Polished stainless steel(PSS)
  - Titanium Plated(Ti)

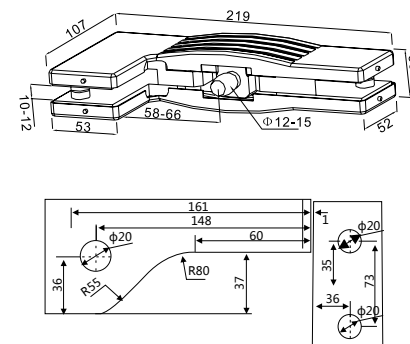

NO.FT3050B (Strike box)

### Dimensions

1. Fit for glass thickness: 10mm 12mm
2. Material:
  - Aluminum alloy;
  - Stainless steel cover plate
3. Finish of the cover plate:
  - Satin stainless steel(SSS)
  - Polished stainless steel(PSS)
  - Titanium Plated(Ti)

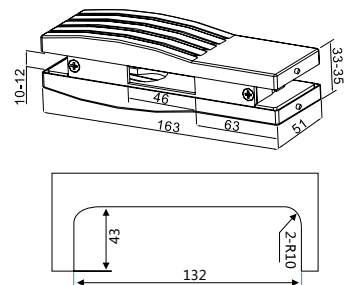



## NO.FT4010 (Bottom patch)

1. Fit for glass thickness: 10mm 12mm
2. Material:  
Aluminum alloy;  
Stainless steel cover plate
3. Finish of the cover plate:  
Satin stainless steel (SSS)  
Polished stainless steel (PSS)  
Titanium Plated (Ti)

Dimensions

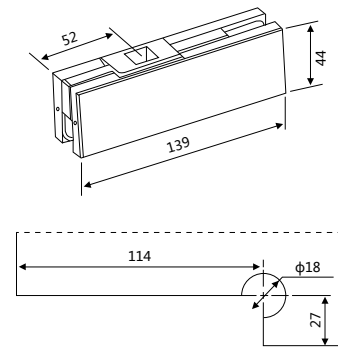

## NO.FT4040 (Overpanel corner "L" patch)

1. Fit for glass thickness: 10mm 12mm
2. Material:  
Aluminum alloy;  
Stainless steel cover plate
3. Finish of the cover plate:  
Satin stainless steel (SSS)  
Polished stainless steel (PSS)  
Titanium Plated (Ti)

Dimensions

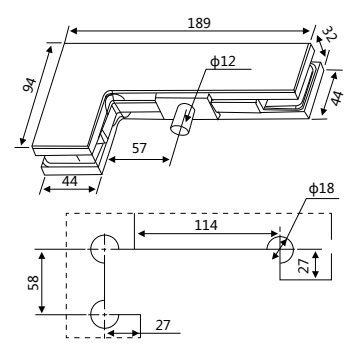

## NO.FT4020 (Top patch)

1. Fit for glass thickness: 10mm 12mm
2. Material:  
Aluminum alloy;  
Stainless steel cover plate
3. Finish of the cover plate:  
Satin stainless steel (SSS)  
Polished stainless steel (PSS)  
Titanium Plated (Ti)

Dimensions

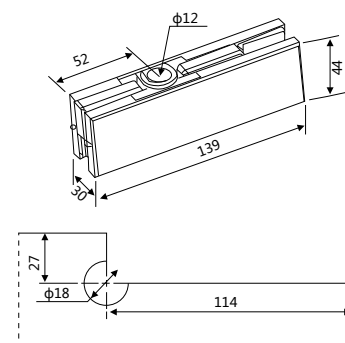

## NO.FT4050 (Center lock)

1. Fit for glass thickness: 10mm 12mm
2. Material:  
Aluminum alloy;  
Stainless steel cover plate
3. Finish of the cover plate:  
Satin stainless steel (SSS)  
Polished stainless steel (PSS)  
Titanium Plated (Ti)

Dimensions

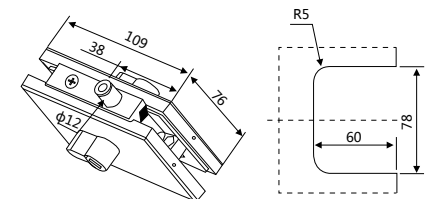

## NO.FT4030P (Overpanel pivot patch with plate)

1. Fit for glass thickness: 10mm 12mm
2. Material:  
Aluminum alloy;  
Stainless steel cover plate
3. Finish of the cover plate:  
Satin stainless steel (SSS)  
Polished stainless steel (PSS)  
Titanium Plated (Ti)

Dimensions

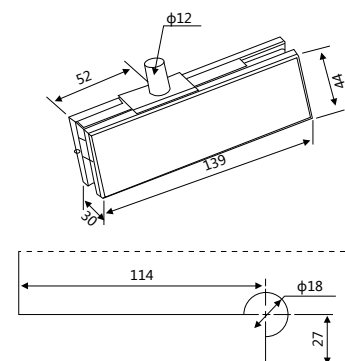

## NO.FT4050B (Strike box)

1. Fit for glass thickness: 10mm 12mm
2. Material:  
Aluminum alloy;  
Stainless steel cover plate
3. Finish of the cover plate:  
Satin stainless steel (SSS)  
Polished stainless steel (PSS)  
Titanium Plated (Ti)

Dimensions

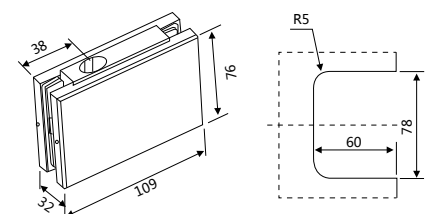



**NEW**



## NO.FT5010 (Bottom patch)

1. Fit for glass thickness: 10mm 12mm
2. Material:
  - Aluminum alloy;
  - Stainless steel cover plate
3. Finish of the cover plate:
  - Satin stainless steel (SSS)
  - Polished stainless steel (PSS)
  - Titanium Plated (Ti)

Dimensions

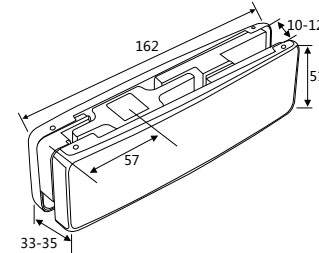

**NEW**



## NO.FT5050 (Center lock)

1. Fit for glass thickness: 10mm 12mm
2. Material:
  - Aluminum alloy;
  - Stainless steel cover plate
3. Finish of the cover plate:
  - Satin stainless steel (SSS)
  - Polished stainless steel (PSS)
  - Titanium Plated (Ti)

Dimensions

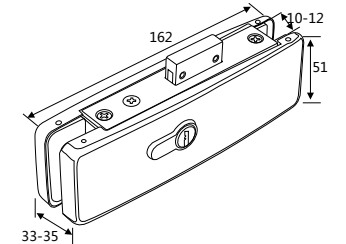

**NEW**



## NO.FT5020 (Top patch)

1. Fit for glass thickness: 10mm 12mm
2. Material:
  - Aluminum alloy;
  - Stainless steel cover plate
3. Finish of the cover plate:
  - Satin stainless steel (SSS)
  - Polished stainless steel (PSS)
  - Titanium Plated (Ti)

Dimensions

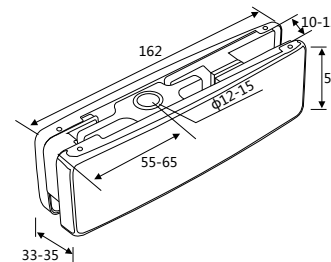

**NEW**



## NO.FT5050B (Strike box)

1. Fit for glass thickness: 10mm 12mm
2. Material:
  - Aluminum alloy;
  - Stainless steel cover plate
3. Finish of the cover plate:
  - Satin stainless steel (SSS)
  - Polished stainless steel (PSS)
  - Titanium Plated (Ti)

Dimensions

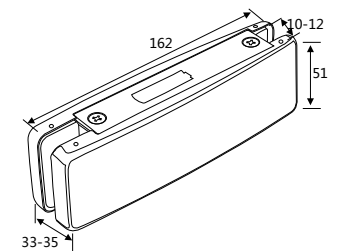

**NEW**



## NO.FT5040 (Overpanel corner "L" patch)

1. Fit for glass thickness: 10mm 12mm
2. Material:
  - Aluminum alloy;
  - Stainless steel cover plate
3. Finish of the cover plate:
  - Satin stainless steel (SSS)
  - Polished stainless steel (PSS)
  - Titanium Plated (Ti)

Dimensions

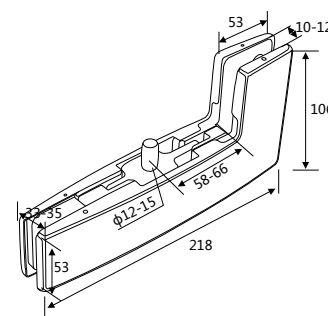

## NO.FT7010 (Bottom patch)

1. Fit for glass thickness: 10mm 12mm
2. Material:
  - Aluminum alloy;
  - Stainless steel cover plate
3. Finish of the cover plate:
  - Satin stainless steel (SSS)
  - Polished stainless steel (PSS)
  - Titanium Plated (Ti)

Dimensions

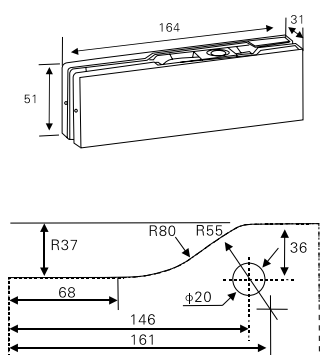



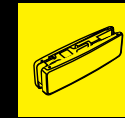

NO.FT7020 ( Top patch )



1. Fit for glass thickness: 10mm 12mm
2. Material:
  - Aluminum alloy;
  - Stainless steel cover plate
3. Finish of the cover plate:
  - Satin stainless steel(SSS)
  - Polished stainless steel(PSS)
  - Titanium Plated(Ti)

## NO.FT705 ( Corner patch )



1. Fit for glass thickness: 10mm 12mm
2. Material:  
Aluminum alloy;  
Stainless steel cover plate
3. Finish of the cover plate:  
Satin stainless steel(SSS)  
Polished stainless steel(PSS)  
Titanium Plated(Ti)

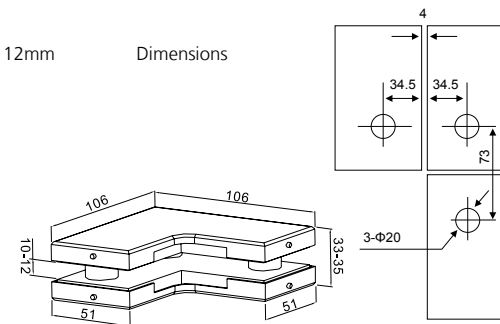

## NO.FT705B ( Corner patch )



1. Fit for glass thickness: 10mm 12mm
2. Material:  
Aluminum alloy;  
Stainless steel cover plate
3. Finish of the cover plate:  
Satin stainless steel(SSS)  
Polished stainless steel(PSS)  
Titanium Plated(Ti)

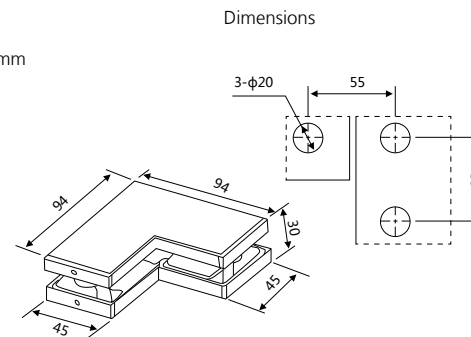

## NO.FT709L ( Overpanel "L" patch with fin )



1. Fit for glass thickness: 10mm 12mm
2. Material:  
Aluminum alloy;  
Stainless steel cover plate
3. Finish of the cover plate:  
Satin stainless steel(SSS)  
Polished stainless steel(PSS)  
Titanium Plated(Ti)

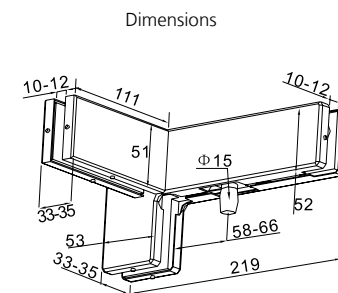

## NO.FT709R ( Overpanel "R" patch with fin )



1. Fit for glass thickness: 10mm 12mm
2. Material:  
Aluminum alloy;  
Stainless steel cover plate
3. Finish of the cover plate:  
Satin stainless steel(SSS)  
Polished stainless steel(PSS)  
Titanium Plated(Ti)

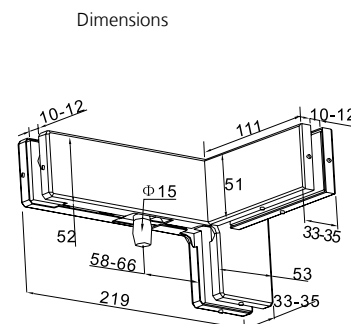

## NO.FT710 ( Double patch with finT )



1. Fit for glass thickness: 10mm 12mm
2. Material:  
Aluminum alloy;  
Stainless steel cover plate
3. Finish of the cover plate:  
Satin stainless steel(SSS)  
Polished stainless steel(PSS)  
Titanium Plated(Ti)

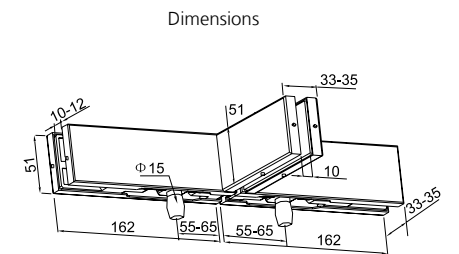

## NO.FT713 ( Connector for 4 glass panels )



1. Fit for glass thickness: 10mm 12mm
2. Material:  
Aluminum alloy;  
Stainless steel cover plate
3. Finish of the cover plate:  
Satin stainless steel(SSS)  
Polished stainless steel(PSS)  
Titanium Plated(Ti)

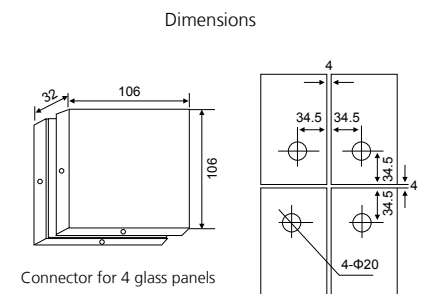

## NO.FT715 ( Connector for 2 glass panels with screw )



1. Fit for glass thickness: 10mm 12mm
2. Material:  
Aluminum alloy;  
Stainless steel cover plate
3. Finish of the cover plate:  
Satin stainless steel(SSS)  
Polished stainless steel(PSS)  
Titanium Plated(Ti)

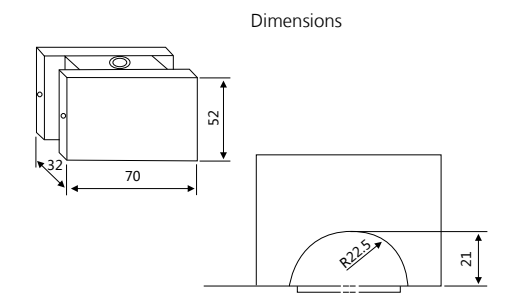

## NO.FT716 ( Connector for 2 glass panels with screw )



1. Fit for glass thickness: 10mm 12mm
2. Material:  
Aluminum alloy;  
Stainless steel cover plate
3. Finish of the cover plate:  
Satin stainless steel(SSS)  
Polished stainless steel(PSS)  
Titanium Plated(Ti)

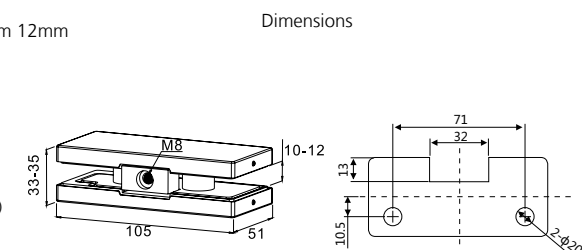

## NO.FT716A (Connector for 2 glass)



- 1.Fit for glass thickness:10mm 12mm
- 2.Material:  
Aluminum alloy;  
Stainless steel cover plate
- 3.Finish of the cover plate:  
Satin stainless steel(SSS)  
Polished stainless steel(PSS)  
Titanium Plated(Ti)

Dimensions

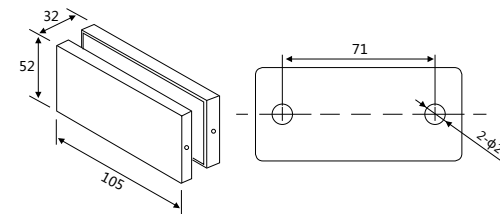

## NO.FT718C (Connector for glass panel)

- 1.Fit for glass thickness:10mm 12mm
- 2.Material:  
Aluminum alloy;  
Stainless steel cover plate
- 3.Finish of the cover plate:  
Satin stainless steel(SSS)  
Polished stainless steel(PSS)  
Titanium Plated(Ti)

Dimensions

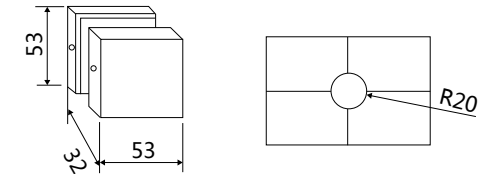

## NO.FT717 (Turn knob lock)



- 1.Fit for glass thickness:10mm 12mm
- 2.Material:  
Aluminum alloy;  
Stainless steel cover plate
- 3.Finish of the cover plate:  
Satin stainless steel(SSS)  
Polished stainless steel(PSS)  
Titanium Plated(Ti)

Dimensions

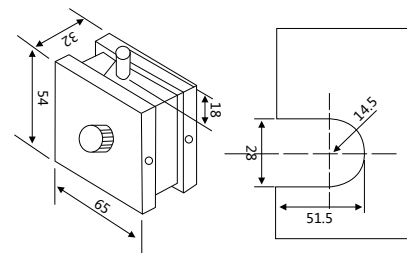

## NO.FT719 (Overpanel connector with fin)

- 1.Fit for glass thickness:10mm 12mm
- 2.Material:  
Aluminum alloy;  
Stainless steel cover plate
- 3.Finish of the cover plate:  
Satin stainless steel(SSS)  
Polished stainless steel(PSS)  
Titanium Plated(Ti)

Dimensions

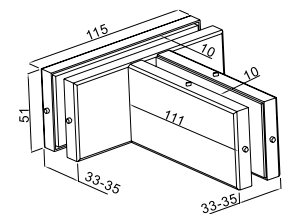

## NO.FT718 (Strike box)



- 1.Fit for glass thickness:10mm 12mm
- 2.Material:  
Aluminum alloy;  
Stainless steel cover plate
- 3.Finish of the cover plate:  
Satin stainless steel(SSS)  
Polished stainless steel(PSS)  
Titanium Plated(Ti)

Dimensions

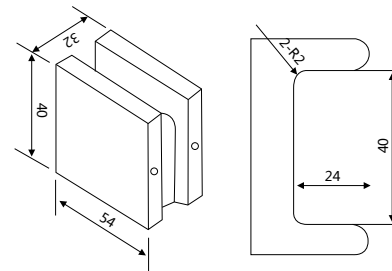

## NO.FT720 (Connector for 4 glass panels with fin)

- 1.Fit for glass thickness:10mm 12mm
- 2.Material:  
Aluminum alloy;  
Stainless steel cover plate
- 3.Finish of the cover plate:  
Satin stainless steel(SSS)  
Polished stainless steel(PSS)  
Titanium Plated(Ti)

Dimensions

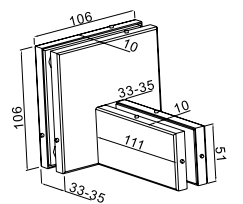

## NO.FT718B (Connector for glass panel)



- 1.Fit for glass thickness:10mm 12mm
- 2.Material:  
Aluminum alloy;  
Stainless steel cover plate
- 3.Finish of the cover plate:  
Satin stainless steel(SSS)  
Polished stainless steel(PSS)  
Titanium Plated(Ti)

Dimensions

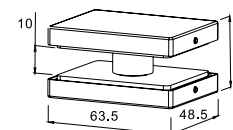

## NO.FT640 (Connector for 2 glass panels with screw)

- 1.Fit for glass thickness:10mm 12mm
- 2.Material:  
Aluminum alloy;  
Zinc-alloy;  
Stainless steel cover plate
- 3.Finish of the cover plate:  
Satin stainless steel(SSS)  
Polished stainless steel(PSS)  
Titanium Plated(Ti)

Dimensions

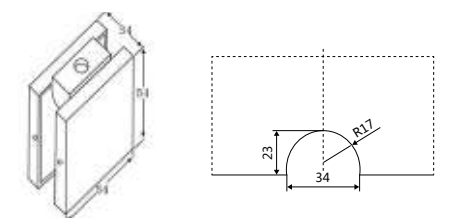



## NO.FT725

Top pivot

Material: Casting stainless steel

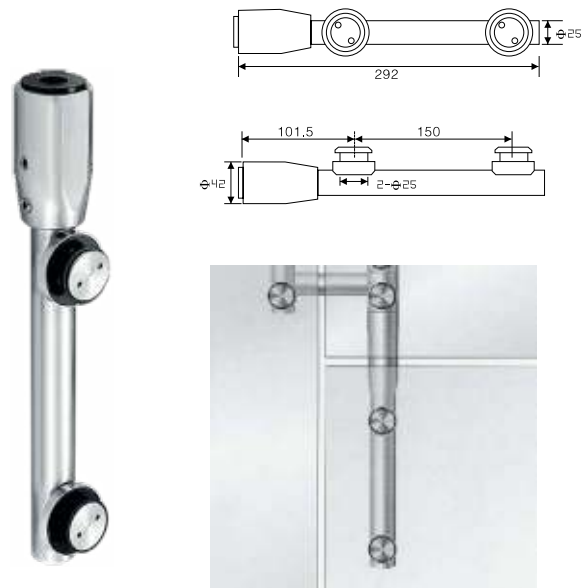

## NO.FT726

Bottom pivot

Material: Casting stainless steel

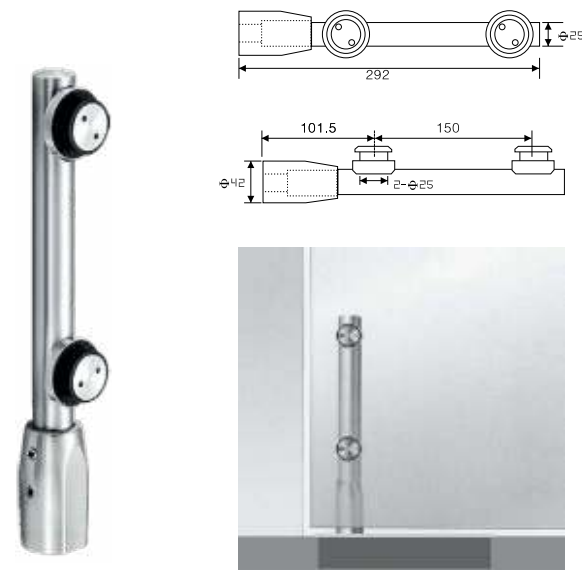

PFACC01(DORMA)



PFACC02(DORMA)



PFACC3(MAB)



PFACC04(MAB)



PFACC05



PFACC06



PFACC07



# GLASS GATE LOCK SERIES







FT9001



Fit for thickness:10-18mm toughened glass  
Material: Zinc alloy,Brass  
Finish: Chrome,Satin nickel,Pearl chrome

FT9004

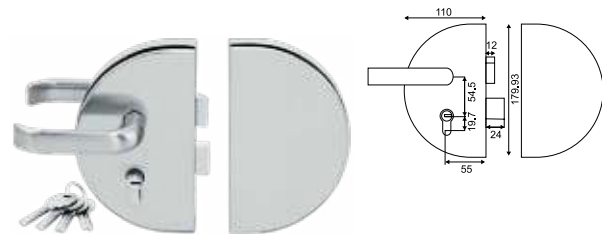

Fit for door thickness:10-18mm toughened glass  
Material: Zinc alloy,Brass  
Finish: Chrome,Satin nickel,Pearl chrome

FT9002

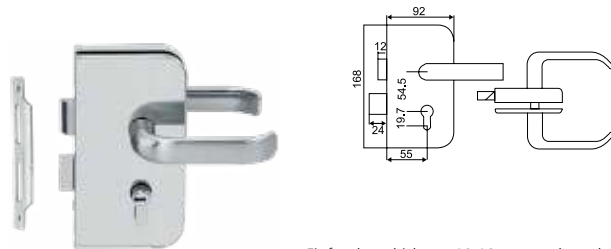

Fit for door thickness:10-18mm toughened glass  
Material: Zinc alloy,Brass  
Finish: Chrome,Satin nickel,Pearl chrome

FT9005

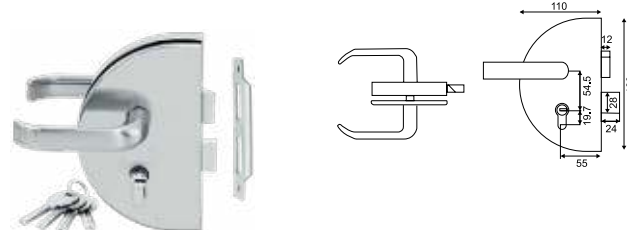

Fit for door thickness:10-18mm toughened glass  
Material: Zinc alloy,Brass  
Finish: Chrome,Satin nickel,Pearl chrome

FT9003



Fit for door thickness:10-18mm toughened glass  
Material: Zinc alloy,Brass  
Finish: Chrome,Satin nickel,Pearl chrome

FT9006

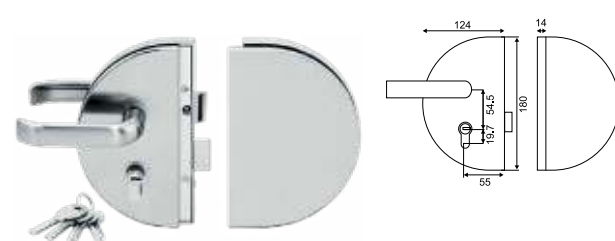

Fit for door thickness:10-18mm toughened glass  
Material: Zinc alloy,Brass  
Finish: Chrome,Satin nickel,Pearl chrome

FT9007



Fit for door thickness:10-18mm toughened glass  
Material: Zinc alloy,Brass  
Finish: Chrome,Satin nickel,Pearl chrome

FT9008



Fit for door thickness:10-18mm toughened glass  
Material: Zinc alloy,Brass  
Finish: Chrome,Satin nickel,Pearl chrome

FT9009

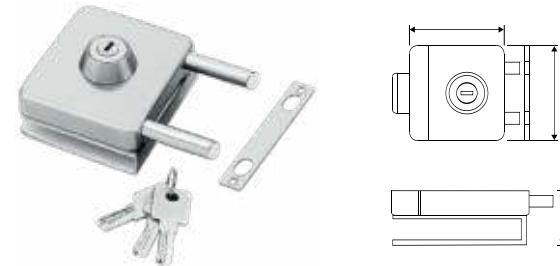

Fit for door thickness:10-18mm toughened glass  
Material: Stainless steel,Iron  
Finish: Satin,Polished

FT9010

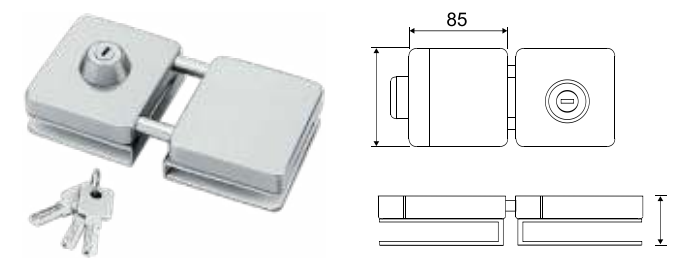

Fit for door thickness:10-18mm toughened glass  
Material: Stainless steel,Iron  
Finish: Satin,Polished

FT9011

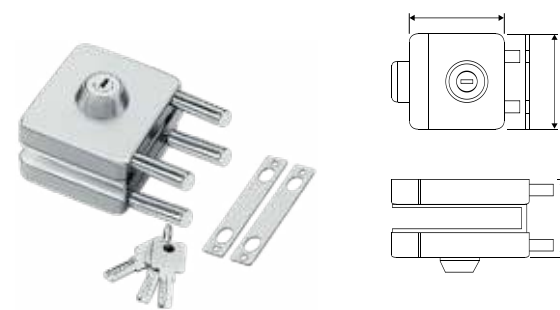

Fit for door thickness:10-18mm toughened glass  
Material: Stainless steel,Iron  
Finish: Satin,Polished

FT9012

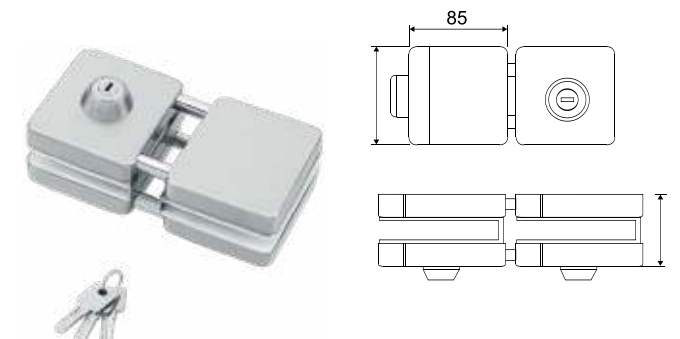

Fit for door thickness:10-18mm toughened glass  
Material: Stainless steel,Iron  
Finish: Satin,Polished

## FT9013

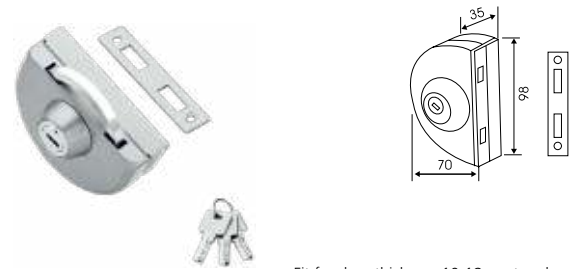

Fit for door thickness: 10-18mm toughened glass  
Material: Stainless steel, Iron  
Finish: Satin, Polished

## FT9014

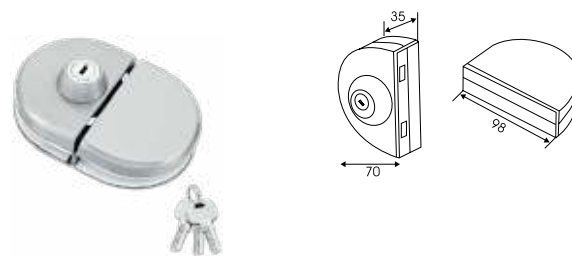

Fit for door thickness: 10-18mm toughened glass  
Material: Stainless steel, Iron  
Finish: Satin, Polished

## FT9021



Fit for door thickness: 10-18mm toughened glass  
Material: Stainless steel, Iron  
Finish: Satin, Polished

## FT9022

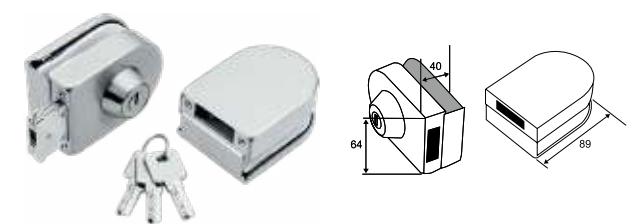

Fit for door thickness: 10-18mm toughened glass  
Material: Stainless steel, Iron  
Finish: Satin, Polished

## FT9015



Fit for door thickness: 10-18mm toughened glass  
Material: Stainless steel, Iron  
Finish: Satin, Polished

## FT9016

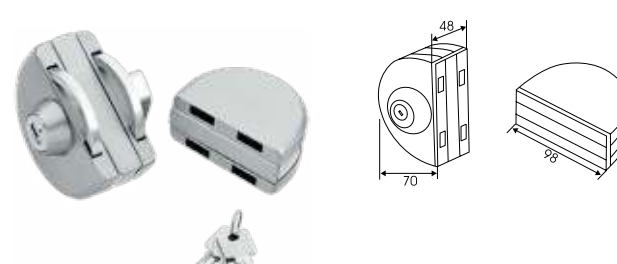

Fit for door thickness: 10-18mm toughened glass  
Material: Stainless steel, Iron  
Finish: Satin, Polished

## FT9023



Fit for door thickness: 10-18mm toughened glass  
Material: Stainless steel, Iron  
Finish: Satin, Polished

## FT9024

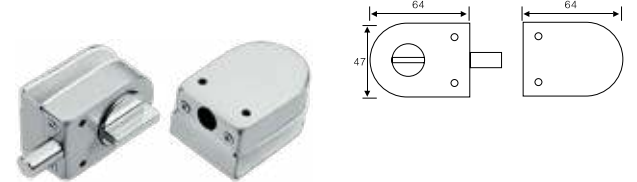

Fit for door thickness: 10-18mm toughened glass  
Material: Stainless steel, Iron  
Finish: Satin, Polished

## FT9017



Fit for door thickness: 10-18mm toughened glass  
Material: Stainless steel, Iron  
Finish: Satin, Polished

## FT9018

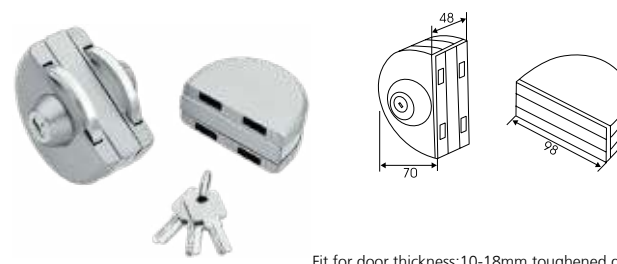

Fit for door thickness: 10-18mm toughened glass  
Material: Stainless steel, Iron  
Finish: Satin, Polished

## FT9025

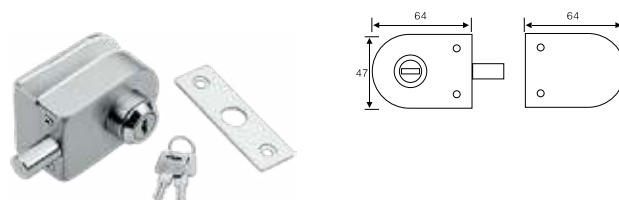

Fit for door thickness: 10-18mm toughened glass  
Material: Stainless steel, Iron  
Finish: Satin, Polished

## FT9026

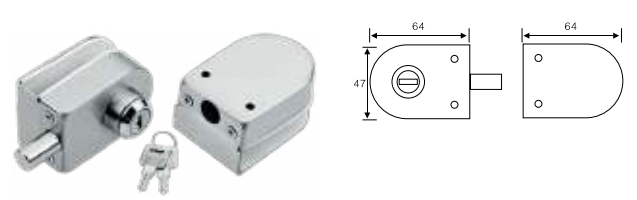

Fit for door thickness: 10-18mm toughened glass  
Material: Stainless steel, Iron  
Finish: Satin, Polished

## FT9019

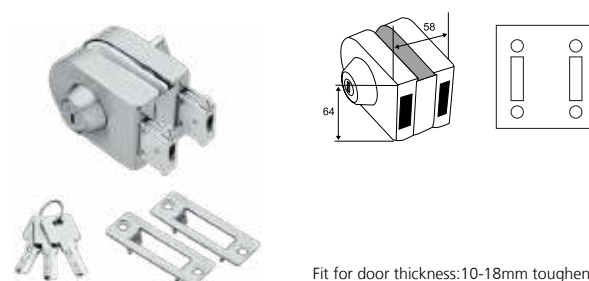

Fit for door thickness: 10-18mm toughened glass  
Material: Stainless steel, Iron  
Finish: Satin, Polished

## FT9020

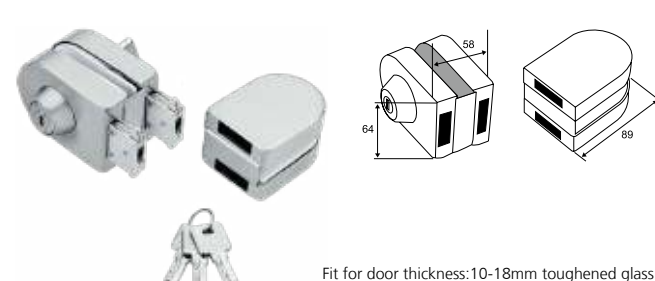

Fit for door thickness: 10-18mm toughened glass  
Material: Stainless steel, Iron  
Finish: Satin, Polished

## FT9027



Fit for door thickness: 10-18mm toughened glass  
Material: Stainless steel, Iron  
Finish: Satin, Polished

## FT9028

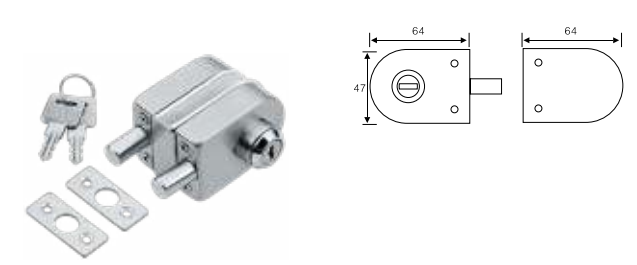

Fit for door thickness: 10-18mm toughened glass  
Material: Stainless steel, Iron  
Finish: Satin, Polished

# HANDLE SERIES

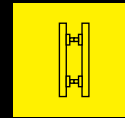

HANDLE SERIES



L1 Mist silver



L2 Bronze



L3 K gold



L4 Orange



L5 Blue grey



L6 Pink



L7 Dark red



L8 Dark red



L9 Purple



L10 Coffee



L11 Titanium



L12 Bronze



L13 Light blue



L14 Apple green



L15 Deep blue



L16 Green



L17 Deep blue



L18 Black



L19 Iron ash



L20 Bronze



L21 Mei red



L22 Purple blue



L23 Green bronze



W1 Mist silver



W2 Bronze



W3 K gold



W4 Orange



W5 Blue grey



W6 Pink



W7 Dark red



W8 Dark red



W9 Purple



W10 Coffee



W11 Titanium



W12 Bronze



W13 Light blue



W14 Apple green



W15 Deep blue



W16 Green



W17 Deep blue



W18 Black



W19 Iron ash



W20 Bronze



W21 Mei red



W22 Purple blue



W23 Green bronze



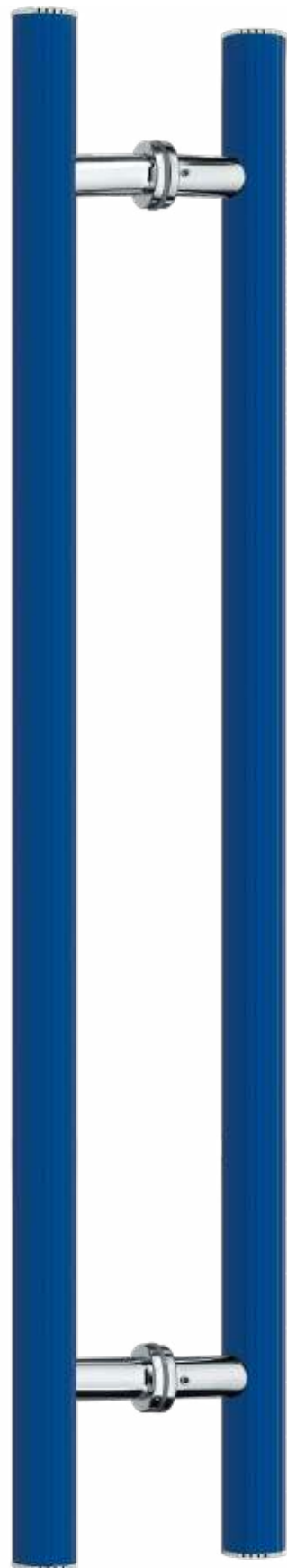

Adjustable Aluminum Handle

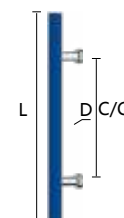

FT-A801

Size(mm)	
L	D
600~3000	40

Material: Aluminium  
Finish: Polish/Satin/Electrophoresis

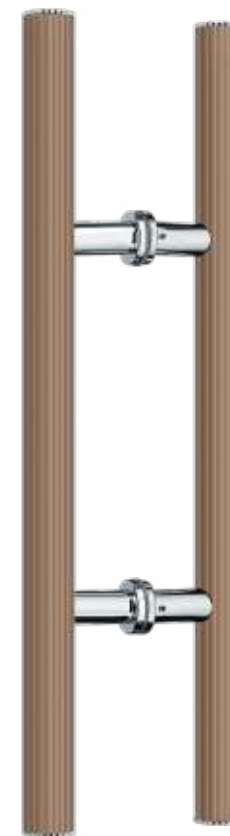

FT-A802

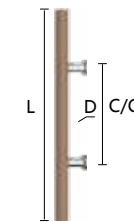

Size(mm)	
L	D
600~3000	40

Material: Aluminium  
Finish: Polish/Satin/Electrophoresis



FT-A803

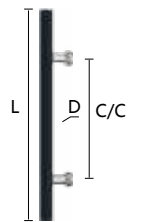

Size(mm)	
L	D
600~3000	40

Material: Aluminium  
Finish: Polish/Satin/Electrophoresis

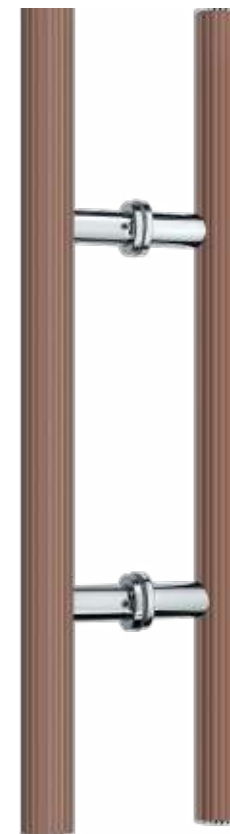

FT-A804

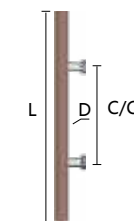

Size(mm)	
L	D
600~3000	40

Material: Aluminium  
Finish: Polish/Satin/Electrophoresis



FT-A805

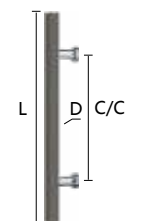

Size(mm)	
L	D
600~3000	40

Material: Aluminium  
Finish: Polish/Satin/Electrophoresis



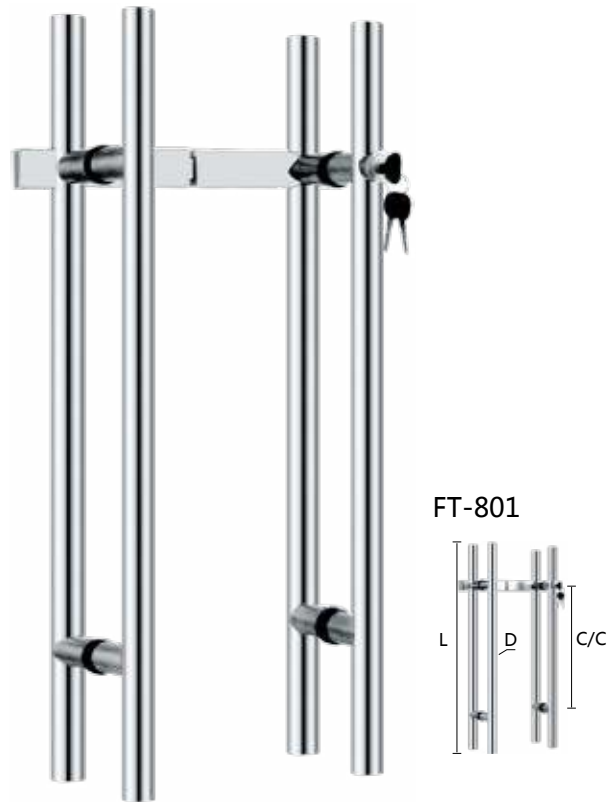

FT-801

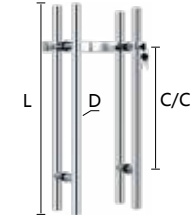

Size

L	C/C	D
600	400	Φ35
800	500	Φ35

Material: Stainless steel  
Finish: Satin Stainless Steel (SSS)  
Polished Stainless Steel (PSS)  
Titanium Plated (Ti)  
Semi-satin



FT-802

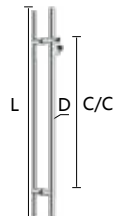

Size

L	C/C	D
1500	1120	Φ35

Material: Stainless steel  
Finish: Satin Stainless Steel (SSS)  
Polished Stainless Steel (PSS)  
Titanium Plated (Ti)  
Semi-satin



FT-803

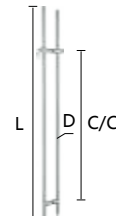

Size

L	C/C	D
1500	1125	Φ35

Material: Stainless steel  
Finish: Satin Stainless Steel (SSS)  
Polished Stainless Steel (PSS)  
Titanium Plated (Ti)  
Semi-satin



FT-804

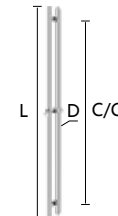

Size

L	C/C	D
2000	1125	Φ35

Material: Stainless steel  
Finish: Satin Stainless Steel (SSS)  
Polished Stainless Steel (PSS)  
Titanium Plated (Ti)  
Semi-satin



FT-847

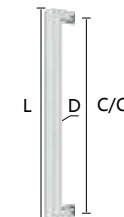

Size

L	C/C	D
300	275	25X13
400	370	30X15

Material: Stainless steel  
Finish: Satin Stainless Steel (SSS)  
Polished Stainless Steel (PSS)  
Titanium Plated (Ti)  
Semi-satin



FT-846

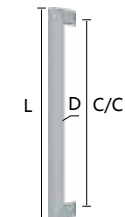

Size

L	C/C	D
600	562	25x38
800	762	25x38
1200	1162	25x38

Material: Stainless steel  
Finish: Satin Stainless Steel (SSS)  
Polished Stainless Steel (PSS)  
Titanium Plated (Ti)  
Semi-satin



FT-865

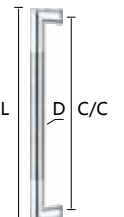

Size

L	C/C	D
300	275	Φ25
600	568	Φ32
800	762	Φ38

Material: Stainless steel  
Finish: Satin Stainless Steel (SSS)  
Polished Stainless Steel (PSS)  
Titanium Plated (Ti)  
Semi-satin



FT-862

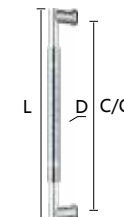

Size

L	C/C	D
600	560	Φ38
800	760	Φ38
1200	1145	Φ51

Material: Stainless steel  
Finish: Satin Stainless Steel (SSS)  
Polished Stainless Steel (PSS)  
Titanium Plated (Ti)  
Semi-satin



FT-869

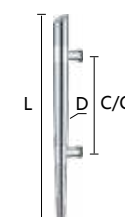

Size

L	C/C	D
300	150	Φ32
450	200	Φ38
600	300	Φ38

Material: Stainless steel  
Finish: Satin Stainless Steel (SSS)  
Polished Stainless Steel (PSS)  
Titanium Plated (Ti)  
Semi-satin



FT-868

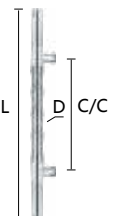

Size

L	C/C	D
600	300	Φ38

Material: Stainless steel  
Finish: Satin Stainless Steel (SSS)  
Polished Stainless Steel (PSS)  
Titanium Plated (Ti)  
Semi-satin



FT-871

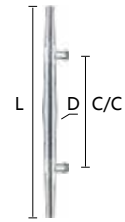

Size		
L	C/C	D
600	400	Φ38

Material: Stainless steel  
Finish: Satin Stainless Steel (SSS)  
Polished Stainless Steel (PSS)  
Titanium Plated (Ti)  
Semi-satin



FT-872

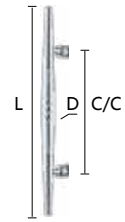

Size		
L	C/C	D
600	400	Φ38

Material: Stainless steel  
Finish: Satin Stainless Steel (SSS)  
Polished Stainless Steel (PSS)  
Titanium Plated (Ti)  
Semi-satin



FT-873

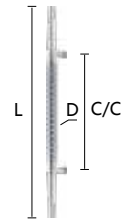

Size		
L	C/C	D
600	400	Φ38

Material: Stainless steel  
Finish: Satin Stainless Steel (SSS)  
Polished Stainless Steel (PSS)  
Titanium Plated (Ti)  
Semi-satin



FT-891

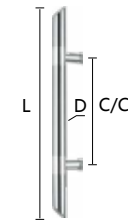

Size		
L	C/C	D
800	500	Φ38
600	300	Φ32

Material: Stainless steel  
Finish: Satin Stainless Steel (SSS)  
Polished Stainless Steel (PSS)  
Titanium Plated (Ti)  
Semi-satin



FT-8101

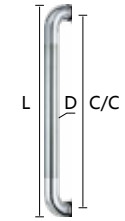

Size		
L	C/C	D
300	275	Φ25
450	418	Φ32
600	568	Φ32

Material: Stainless steel  
Finish: Satin Stainless Steel (SSS)  
Polished Stainless Steel (PSS)  
Titanium Plated (Ti)  
Semi-satin

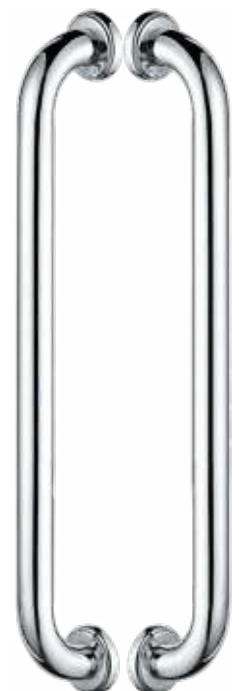

FT-8100

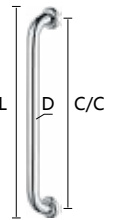

Size		
L	C/C	D
500	468	Φ32

Material: Stainless steel  
Finish: Satin Stainless Steel (SSS)  
Polished Stainless Steel (PSS)  
Titanium Plated (Ti)  
Semi-satin



FT-882

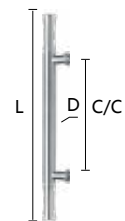

Size		
L	C/C	D
600	300	Φ38
1200	700	Φ51

Material: Stainless steel  
Finish: Satin Stainless Steel (SSS)  
Polished Stainless Steel (PSS)  
Titanium Plated (Ti)  
Semi-satin

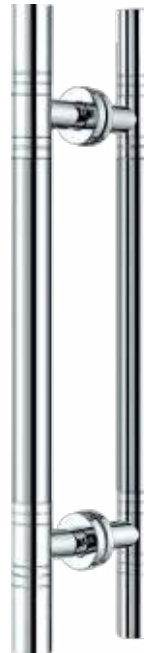

FT-864

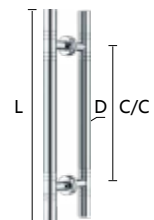

Size		
L	C/C	D
450	300	Φ32
600	400	Φ38
800	500	Φ32
800	600	Φ38

Material: Stainless steel  
Finish: Satin Stainless Steel (SSS)  
Polished Stainless Steel (PSS)  
Titanium Plated (Ti)  
Semi-satin



FT-883

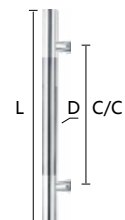

Size		
L	C/C	D
300	200	Φ25
450	300	Φ32
600	400	Φ32
1200	800	Φ38
1800	1400	Φ38

Material: Stainless steel  
Finish: Satin Stainless Steel (SSS)  
Polished Stainless Steel (PSS)  
Titanium Plated (Ti)  
Semi-satin



FT-8107

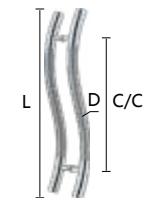

Size		
L	C/C	D
500	400	Φ32
600	400	Φ38

Material: Stainless steel  
Finish: Satin Stainless Steel (SSS)  
Polished Stainless Steel (PSS)  
Titanium Plated (Ti)  
Semi-satin



FT-8119

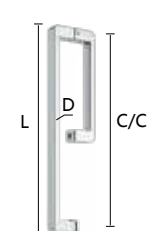

Size		
L	C/C	D
450x250	425x225	25x25

Material: Stainless steel  
Finish: Satin Stainless Steel (SSS)  
Polished Stainless Steel (PSS)  
Titanium Plated (Ti)  
Semi-satin



FT-8113

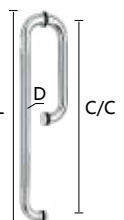

Size		
L	C/C	D
200X400	181X381	Φ19
250X450	225X425	Φ25
300X500	275X475	Φ32

Material: Stainless steel  
Finish: Satin Stainless Steel (SSS)  
Polished Stainless Steel (PSS)  
Titanium Plated (Ti)  
Semi-satin

# SHOWER HINGE SERIES



FT-8114

Size

L	C/C	D
200x500	175x475	Φ25

Material: Stainless steel  
Finish: Satin Stainless Steel (SSS)  
Polished Stainless Steel (PSS)  
Titanium Plated (Ti)  
Semi-satin



FT-8123

Size

L	C/C	D
300	275	Φ25
450	418	Φ32
600	568	Φ32

Material: Stainless steel  
Finish: Satin Stainless Steel (SSS)  
Polished Stainless Steel (PSS)  
Titanium Plated (Ti)  
Semi-satin



FT-8126

Size

L	C/C	D
300	120	Φ25
450	200	Φ32
600	300	Φ38

Material: Stainless steel  
Finish: Satin Stainless Steel (SSS)  
Polished Stainless Steel (PSS)  
Titanium Plated (Ti)  
Semi-satin



FT-8117

Size

L	C/C	D
200	175	Φ25
332	300	Φ32

Material: Stainless steel  
Finish: Satin Stainless Steel (SSS)  
Polished Stainless Steel (PSS)  
Titanium Plated (Ti)  
Semi-satin



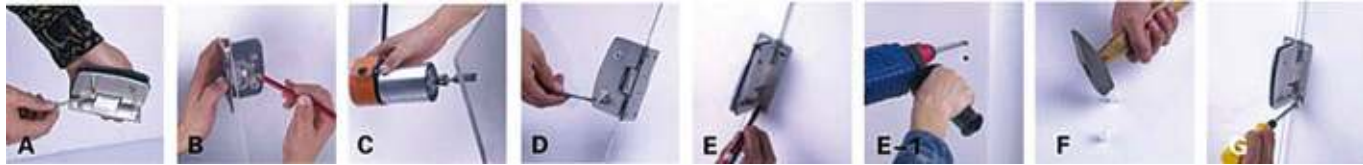

## SHOWER HINGE INSTALLATION STEPS:

A.Remove the plate.

B.Draw lines at the appropriate positions on the glass according to the instructions.

C.Drill holes on the glass.

D.Install the hinge on one side of the glass and screw down the screws. Remember not to leave the rubber mat behind.

E.Drill holes on the wall.

F.Knock the rubber plunger into the wall.

G.Install the other part of the hinge on the door leaf and screw down the screws.

## SHOWER HINGE FEATURES :

- 1.Refined by using stainless steel
- 2.Through sophisticated lost-wax casting, meticulously polishing materials, simple and elegant tables. solid and durable, corrosion resistant.
- 3.Slotting one-way in the connection between glass and glass door
- 4.Open-close is over 200 thousand times
5. Applicable for glass and glass connection of flat bathroom glass door(Also called 180°clamp)
- 6.Specification is 100×100, can keep closed position, and hold open at 90° position inside or outside
- 7.Fit for 10~12mm thickness glass door
- 8.Max Bearing weight: 40kg/pairs



## FT1003

Wall to glass

Applicable for 800-1000mm wide and 8-12mm thick glass door, Door will be close automatically at approximately 25°

Note: glass must be toughened

Bearing weight: 40kg/Pair

Material: Brass,stainless steel,zinc alloy

Finish:Satin Nickel ,Chrome Plated

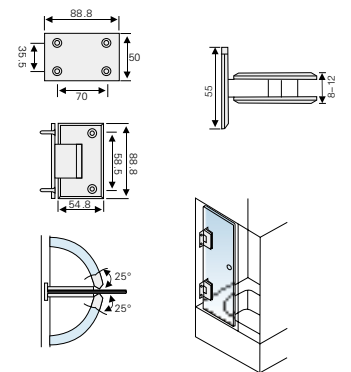

## FT1004

Glass to glass 135°

Applicable for 800-1000mm wide and 8-12mm thick glass door, Door will be close automatically at approximately 25°

Note: glass must be toughened

Bearing weight: 40kg/Pair

Material: Brass,stainless steel,zinc alloy

Finish:Satin Nickel ,Chrome Plated

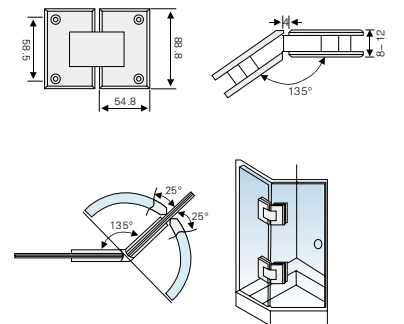

## FT1001

Fix clip 0°

Applicable for 800-1000mm wide and 8-12mm thick glass door, Door will be close automatically at approximately 25°

Note: glass must be toughened

Bearing weight: 40kg/Pair

Material: Brass,stainless steel,zinc alloy

Finish:Satin Nickel ,Chrome Plated

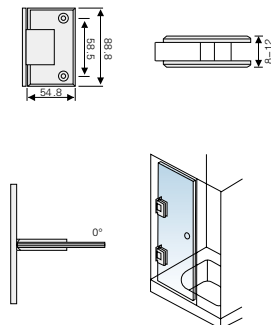

## FT1002

Wall to glass one way

Applicable for 800-1000mm wide and 8-12mm thick glass door, Door will be close automatically at approximately 25°

Note: glass must be toughened

Bearing weight: 40kg/Pair

Material: Brass,stainless steel,zinc alloy

Finish:Satin Nickel ,Chrome Plated

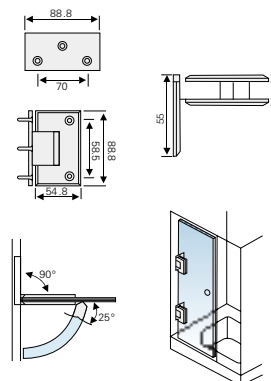

## FT1006

Glass to glass 90°

Applicable for 800-1000mm wide and 8-12mm thick glass door, Door will be close automatically at approximately 25°

Note: glass must be toughened

Bearing weight: 40kg/Pair

Material: Brass,stainless steel,zinc alloy

Finish:Satin Nickel ,Chrome Plated

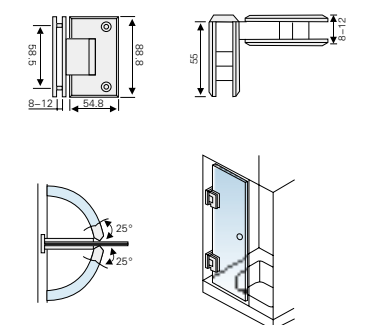



## FT1007

Fix clip 0°

Applicable for 800-1000mm wide and 8-12mm thick glass door,  
Door will be close automatically at approximately 25°

Note: glass must be toughened

Bearing weight: 40kg/Pair

Material: Brass,stainless steel,zinc alloy

Finish:Satin Nickel ,Chrome Plated

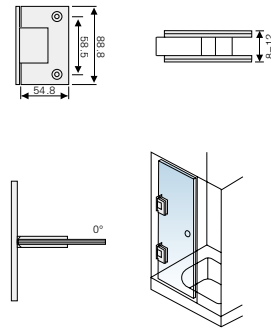

## FT1008

Wall to glass one way

Applicable for 800-1000mm wide and 8-12mm thick glass door,  
Door will be close automatically at approximately 25°

Note: glass must be toughened

Bearing weight: 40kg/Pair

Material: Brass,stainless steel,zinc alloy

Finish:Satin Nickel ,Chrome Plated

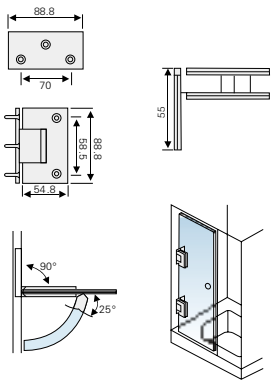

## FT1009

Wall to glass

Applicable for 800-1000mm wide and 8-12mm thick glass door,  
Door will be close automatically at approximately 25°

Note: glass must be toughened

Bearing weight: 40kg/Pair

Material: Brass,stainless steel,zinc alloy

Finish:Satin Nickel ,Chrome Plated

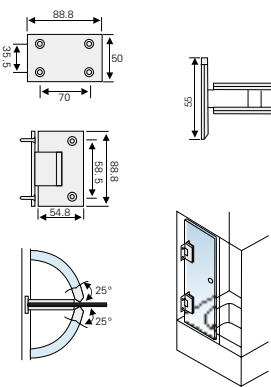

## FT1010

Glass to glass 135°

Applicable for 800-1000mm wide and 8-12mm thick glass door,  
Door will be close automatically at approximately 25°

Note: glass must be toughened

Bearing weight: 40kg/Pair

Material: Brass,stainless steel,zinc alloy

Finish:Satin Nickel ,Chrome Plated

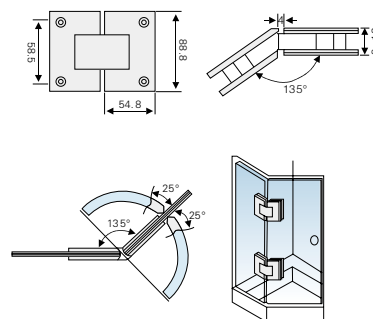

## FT1011

Glass to glass 180°

Applicable for 800-1000mm wide and 8-12mm thick glass door,  
Door will be close automatically at approximately 25°

Note: glass must be toughened

Bearing weight: 40kg/Pair

Material: Brass,stainless steel,zinc alloy

Finish:Satin Nickel ,Chrome Plated

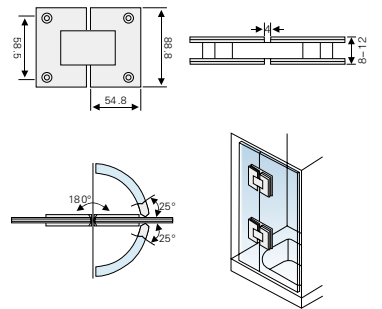

## FT1012

Glass to glass 90°

Applicable for 800-1000mm wide and 8-12mm thick glass door,  
Door will be close automatically at approximately 25°

Note: glass must be toughened

Bearing weight: 40kg/Pair

Material: Brass,stainless steel,zinc alloy

Finish:Satin Nickel ,Chrome Plated

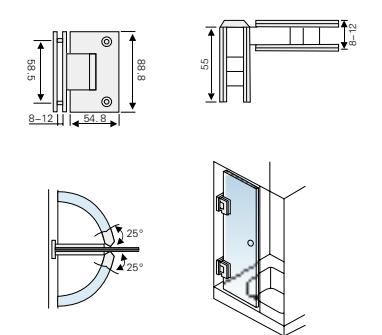

## FT1019

Fix clip 0°

Applicable for 800-1000mm wide and 8-12mm thick glass door,  
Door will be close automatically at approximately 25°

Note: glass must be toughened

Bearing weight: 40kg/Pair

Material: Brass,stainless steel,zinc alloy

Finish:Satin Nickel ,Chrome Plated

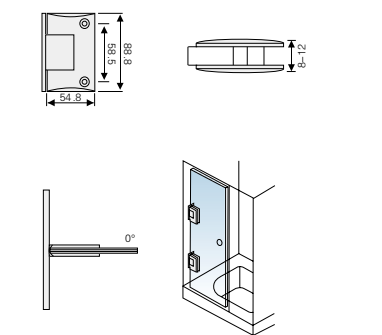

## FT1020

Wall to glass one way

Applicable for 800-1000mm wide and 8-12mm thick glass door,  
Door will be close automatically at approximately 25°

Note: glass must be toughened

Bearing weight: 40kg/Pair

Material: Brass,stainless steel,zinc alloy

Finish:Satin Nickel ,Chrome Plated

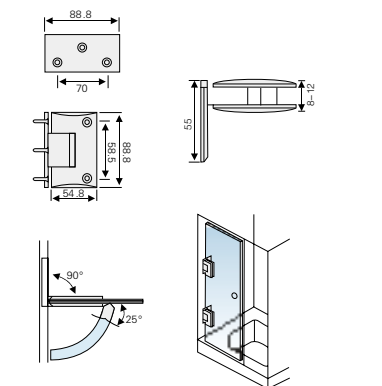



## FT1021

Wall to glass

Applicable for 800-1000mm wide and 8-12mm thick glass door,  
Door will be close automatically at approximately 25°

Note: glass must be toughened  
Bearing weight: 40kg/Pair  
Material: Brass, stainless steel, zinc alloy  
Finish: Satin Nickel, Chrome Plated

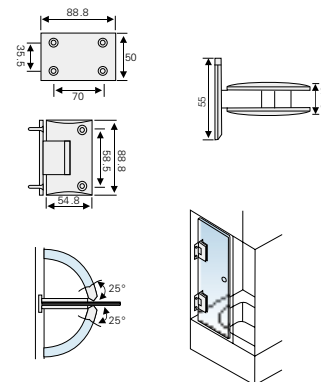

## FT1022

Glass to glass 135°

Applicable for 800-1000mm wide and 8-12mm thick glass door,  
Door will be close automatically at approximately 25°

Note: glass must be toughened  
Bearing weight: 40kg/Pair  
Material: Brass, stainless steel, zinc alloy  
Finish: Satin Nickel, Chrome Plated

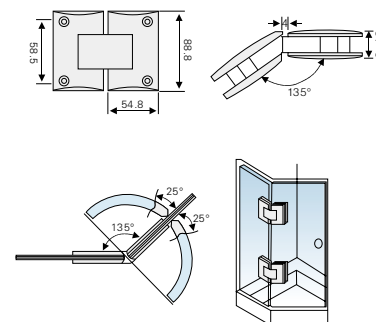

## FT1023

Glass to glass 180°

Applicable for 800-1000mm wide and 8-12mm thick glass door,  
Door will be close automatically at approximately 25°

Note: glass must be toughened  
Bearing weight: 40kg/Pair  
Material: Brass, stainless steel, zinc alloy  
Finish: Satin Nickel, Chrome Plated

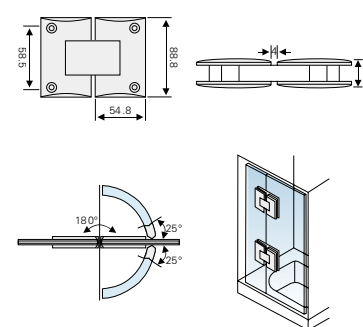

## FT1024

Glass to glass 90°

Applicable for 800-1000mm wide and 8-12mm thick glass door,  
Door will be close automatically at approximately 25°

Note: glass must be toughened  
Bearing weight: 40kg/Pair  
Material: Brass, stainless steel, zinc alloy  
Finish: Satin Nickel, Chrome Plated

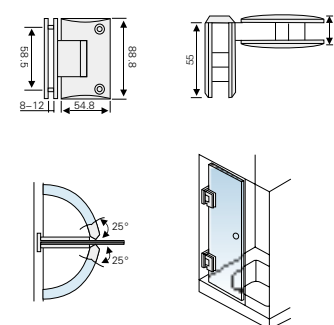

## FT1031

Wall to glass one way

Applicable for 800-1000mm wide and 8-12mm thick glass door,  
Door will be close automatically at approximately 25°

Note: glass must be toughened  
Bearing weight: 45kg/Pair  
Material: Quality stainless steel  
Finish: PSS, SSS

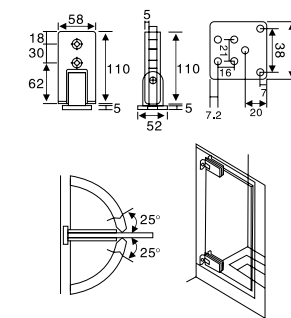

## FT1032

Wall to glass

Applicable for 800-1000mm wide and 8-12mm thick glass door,  
Door will be close automatically at approximately 25°

Note: glass must be toughened  
Bearing weight: 45kg/Pair  
Material: Quality stainless steel  
Finish: PSS, SSS

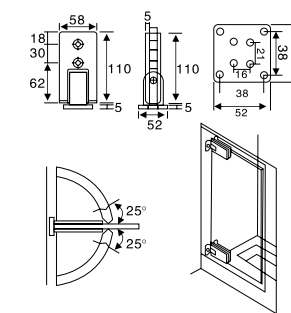

## FT1033

Glass to glass 135°

Applicable for 800-1000mm wide and 8-12mm thick glass door,  
Door will be close automatically at approximately 25°

Note: glass must be toughened  
Bearing weight: 45kg/Pair  
Material: Quality stainless steel  
Finish: PSS, SSS

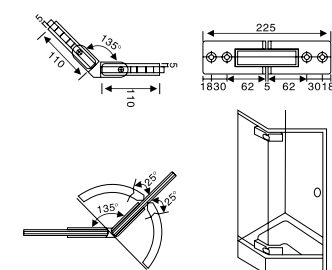

## FT1034

Glass to glass 180°

Applicable for 800-1000mm wide and 8-12mm thick glass door,  
Door will be close automatically at approximately 25°

Note: glass must be toughened  
Bearing weight: 45kg/Pair  
Material: Quality stainless steel  
Finish: PSS, SSS

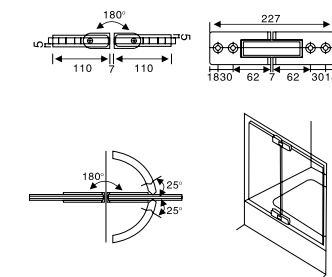



# GLASS CONNECTOR SERIES

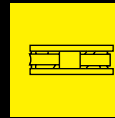

Size: 8-10mm toughened glass | Finish: Satin nickel, chrome plated | Material: Brass, stainless steel and zinc-alloy

## FT1050

Fix clip 0°

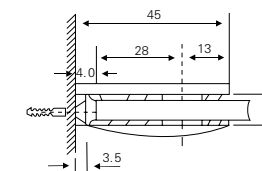

## FT1051

Single 90°

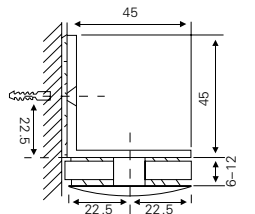

## FT1052

Double 90°

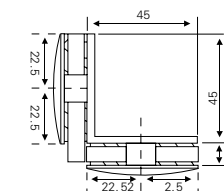

## FT1053

Single 135°

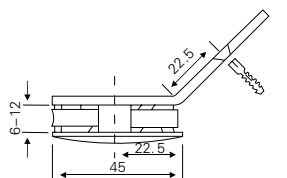

## FT1054

Double 135°

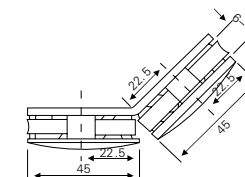

## FT1055

Single 180°

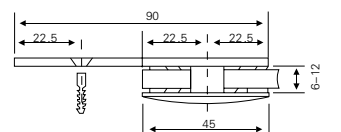

## FT1056

Double 180°

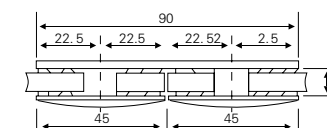

Size: 8-10mm toughened glass | Finish: Satin nickel, chrome plated | Material: Brass, stainless steel and zinc-alloy

### FT1064

Fix clip 0°

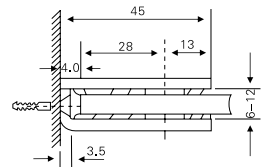

### FT1065

Single 90°

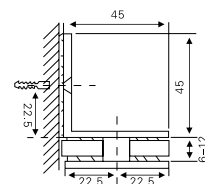

### FT1066

Double 90°

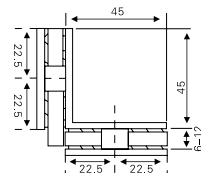

### FT1067

Single 135°

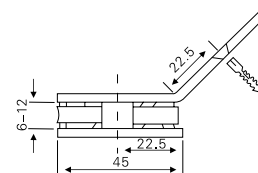

### FT1068

Double 135°

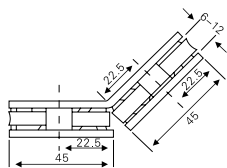

### FT1069

Single 180°

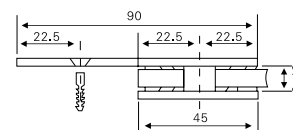

### FT1070

Double 180°

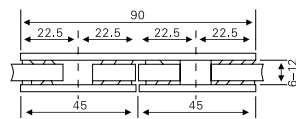

Size: 8-10mm toughened glass | Finish: Satin nickel, chrome plated | Material: stainless steel

### FT1071

Fix clip 0°

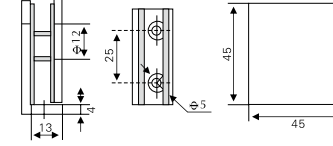

### FT1072

Single 90°

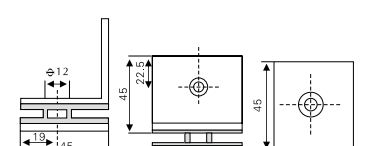

### FT1073

Double 90°

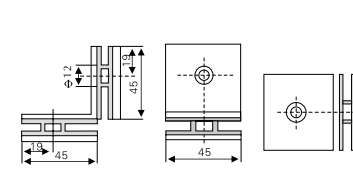

### FT1074

Single 135°

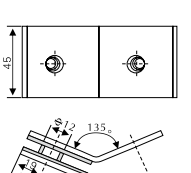

### FT1075

Double 135°

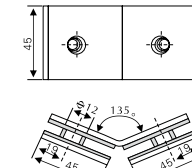

### FT1076

Single 180°

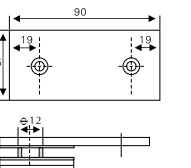

### FT1077

Double 180°

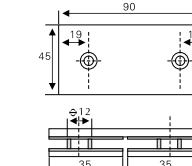

Size:8-10mm toughened glass | Finish:Satin nickel,chrome plated | Material:stainless steel

### FT1078

Fix clip 0°

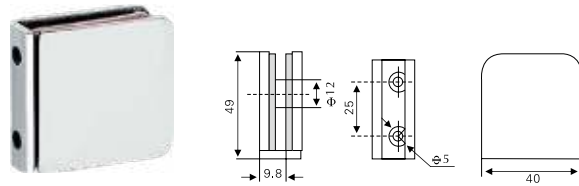

### FT1079

Single 90°

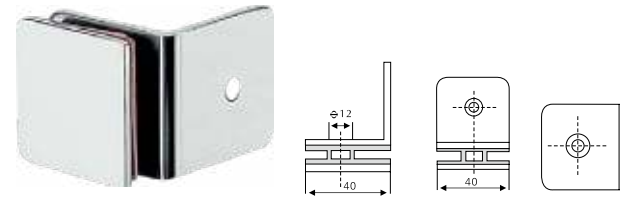

### FT1080

Double 90°

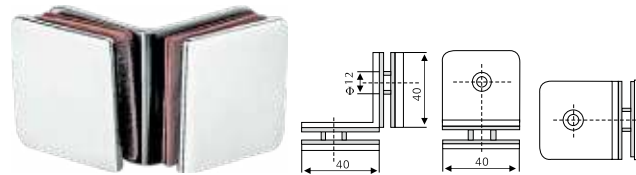

### FT1081

Single 135°



### FT1082

Double 135°



### FT1083

Single 180°



### FT1084

Double 180°



Size:8-10mm toughened glass | Finish:Satin nickel,chrome plated | Material:stainless steel

### FT1085

Fix clip 0°

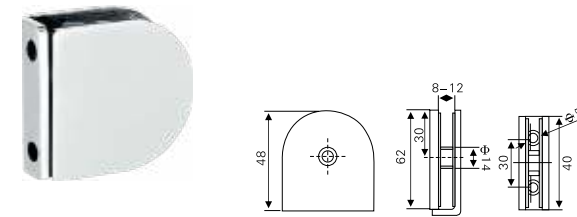

### FT1086

Single 90°

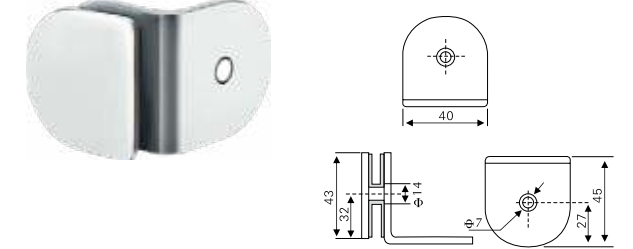

### FT1087

Double 90°

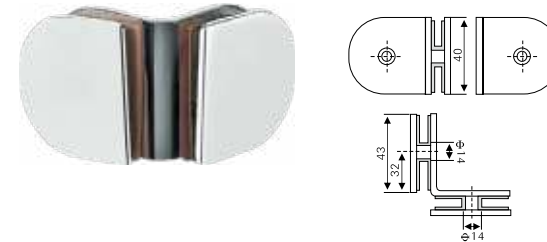

### FT1088

Single 135°

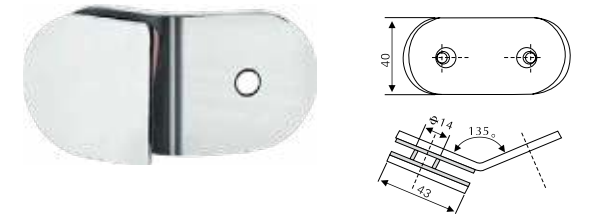

### FT1089

Double 135°

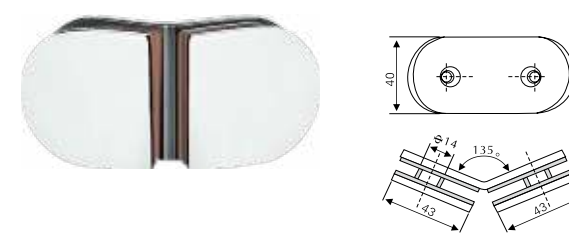

### FT1090

Single 180°

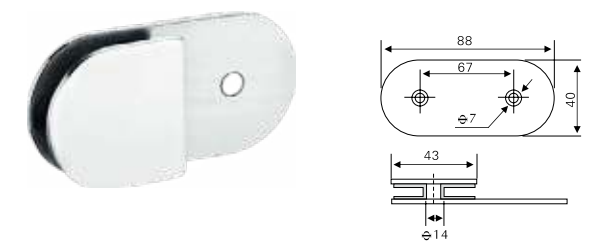

### FT1091

Double 180°





Size:8-10mm toughened glass | Finish:Satin nickel,chrome plated | Material:Zinc-alloy

### FT1092

Fix clip 0°

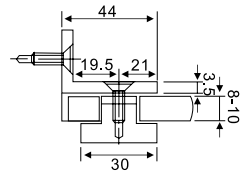

### FT1093

Single 90°

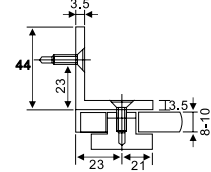

### FT1094

Double 90°

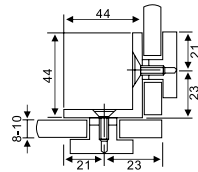

### FT1095

Single 135°

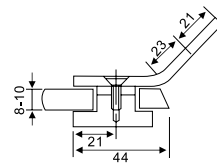

### FT1096

Double 135°

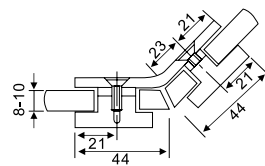

### FT1097

Single 180°

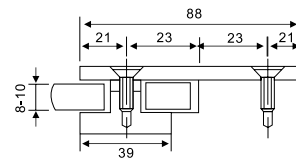

### FT1098

Double 180°

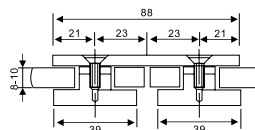

### FT1099

T type

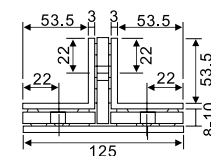

Size:8-10mm toughened glass | Finish:Satin nickel,chrome plated | Material:Zinc-alloy,stainless steel

### FT1100

Fix clip 0°

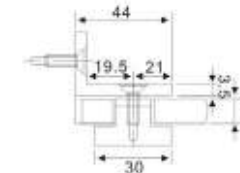

### FT1101

Double 90°

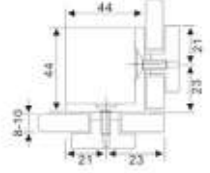

### FT1102

Single 90°

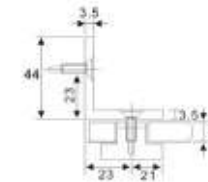

### FT1103

Double 135°

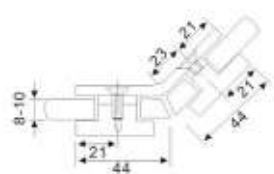

### FT1104

Single 135°

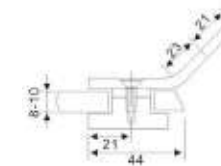

### FT1105

Double 180°

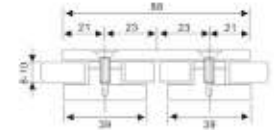

### FT1106

Single 180°

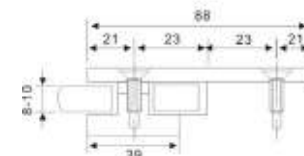

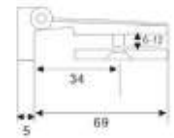

**FT1107**

Material: Zinc Alloy  
Finish: SN, CP

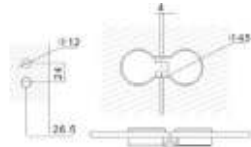

**FT1108**

Material: Zinc Alloy  
Finish: SN, CP

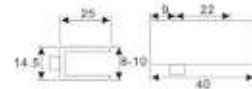

**FT1109**

Material: Zinc Alloy  
Finish: SN, CP

### Installation illustration

Bathroom connector series select pure copper and 304 stainless steel, look concisely and clearly. We have complete sets products, and with many kinds of installation, making installation easier.

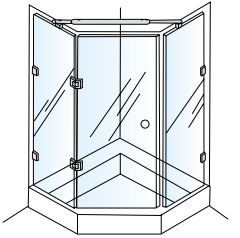
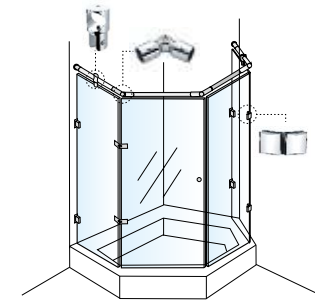

**FT1121**



Finish: SN, CP  
Material: Brass  
Diameter:  $\phi 19$ ,  $\phi 25$   
Available for: bathroom partition

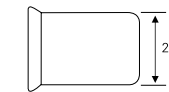

**FT1122**



Finish: SN, CP  
Material: Brass  
Diameter:  $\phi 19$ ,  $\phi 25$   
Available for: bathroom partition

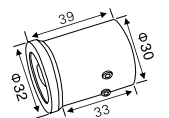

**FT1110**

Material: Aluminum alloy  
Finish: SN, CP  
Size: 42x63mm  
32x54mm



**FT1111**

Material: Stainless steel  
Finish: SSS, PSS  
Size: 45x63x26mm



**FT1112**

Material: Stainless steel  
Finish: SSS, PSS  
Size: 45x63x26mm

**FT1123**



Finish: SN, CP  
Material: Brass, Stainless steel  
Diameter:  $\phi 19$ ,  $\phi 25$   
Available for: bathroom partition

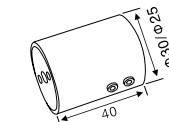

**FT1124**



Finish: SN, CP  
Material: Brass, Stainless steel  
Diameter:  $\phi 19$ ,  $\phi 25$   
Available for: bathroom partition

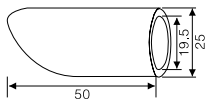

**FT1125**



Finish: SN, CP  
Material: Brass  
Diameter:  $\phi 19$ ,  $\phi 25$   
Available for: bathroom partition

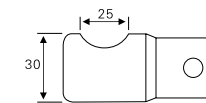

**FT1126**



Finish: SN, CP  
Material: Brass  
Diameter:  $\phi 19$ ,  $\phi 25$   
Available for: bathroom partition

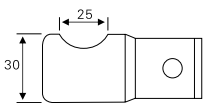

**FT1113**

Material: Stainless steel  
Finish: SSS, PSS  
Size: 45x45mm



**FT1114**

Material: Stainless steel  
Finish: SSS, PSS  
Size: 45x45mm



**FT1115**

Material: Stainless steel  
Finish: SSS, PSS  
Size: 50x45x27mm

**FT1127**



Finish: SN, CP  
Material: Brass  
Diameter:  $\phi 19$ ,  $\phi 25$   
Available for: bathroom partition

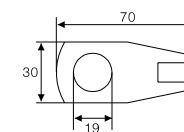

**FT1128**



Finish: SN, CP  
Material: Brass  
Diameter:  $\phi 19$ ,  $\phi 25$   
Available for: bathroom partition

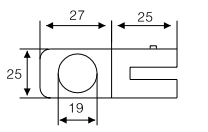

FT1129



Finish: SN,CP  
Material: Brass  
Diameter:  $\phi 19$ ,  $\phi 25$   
Available for: bathroom partition

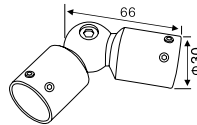

FT1131



Finish: SN,CP  
Material: Brass,Stainless steel  
Diameter:  $\phi 19$ ,  $\phi 25$   
Available for: bathroom partition

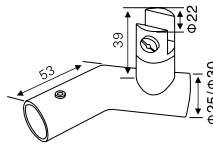

FT1133



Finish: SN,CP  
Material: Brass,Stainless steel  
Diameter:  $\phi 19$ ,  $\phi 25$   
Available for: bathroom partition

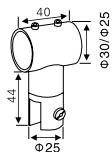

FT1135



Finish: SN,CP  
Material: Stainless steel  
Diameter:  $\phi 19$ ,  $\phi 25$   
Available for: bathroom partition

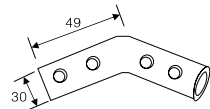

FT1137



Finish: SN,CP  
Material: Stainless steel  
Diameter:  $\phi 19$ ,  $\phi 25$   
Available for: bathroom partition

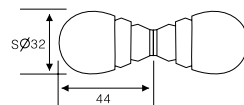

FT1130



Finish: SN,CP  
Material: Brass,Stainless steel  
Diameter:  $\phi 19$ ,  $\phi 25$   
Available for: bathroom partition



FT1132



Finish: SN,CP  
Material: Brass,Stainless steel  
Diameter:  $\phi 19$ ,  $\phi 25$   
Available for: bathroom partition

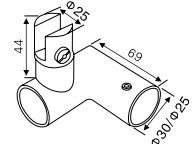

FT1134



Finish: SN,CP  
Material: Stainless steel  
Diameter:  $\phi 19$ ,  $\phi 25$   
Available for: bathroom partition

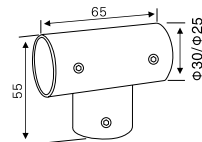

FT1136



Finish: SN,CP  
Material: Stainless steel  
Diameter:  $\phi 19$ ,  $\phi 25$   
Available for: bathroom partition

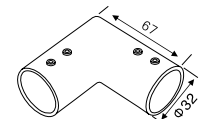

FT1138



**Bathroom knob**  
Material: Brass,aluminum,zinc-alloy,  
stainless steel  
Finish: CP,SN

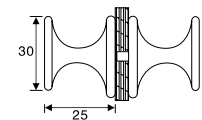

FT1139



**Bathroom knob**  
Material: Brass,aluminum,zinc-alloy,  
stainless steel  
Finish: CP,SN

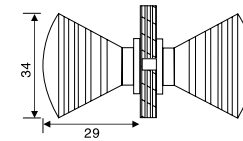

FT1141



**Bathroom knob**  
Material: Brass,aluminum,zinc-alloy,  
stainless steel  
Finish: CP,SN

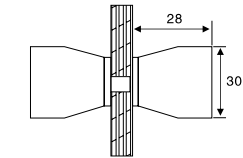

FT1143



**Bathroom knob**  
Material: Brass,aluminum,zinc-alloy,  
stainless steel  
Finish: CP,SN

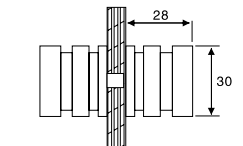

FT1145



**Bathroom knob**  
Material: Brass,aluminum,zinc-alloy,  
stainless steel  
Finish: CP,SN

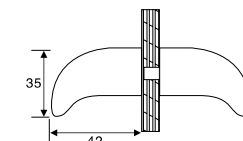

FT1140



**Bathroom knob**  
Material: Brass,aluminum,zinc-alloy,  
stainless steel  
Finish: CP,SN

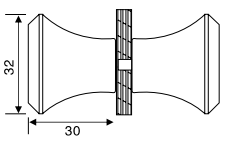

FT1142



**Bathroom knob**  
Material: Brass,aluminum,zinc-alloy,  
stainless steel  
Finish: CP,SN

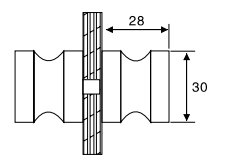

FT1144



**Bathroom knob**  
Material: Brass,aluminum,zinc-alloy,  
stainless steel  
Finish: CP,SN

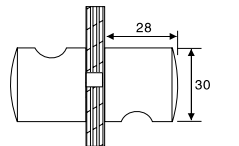

FT1146



**Bathroom knob**  
Material: Brass,aluminum,zinc-alloy,  
stainless steel  
Finish: CP,SN

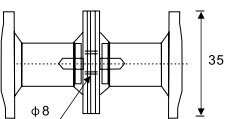



## FT1147

**Bathroom knob**  
Material: Brass,aluminum,zinc-alloy,  
stainless steel  
Finish: CP,SN

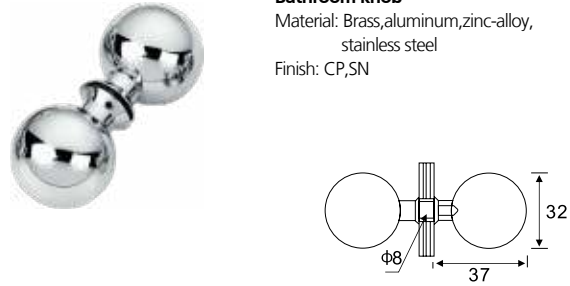

## FT1148

**Bathroom knob**  
Material: Brass,aluminum,zinc-alloy,  
stainless steel  
Finish: CP,SN



## FT1149

**Bathroom knob**  
Material: aluminum,stainless steel  
Finish: CP,SN

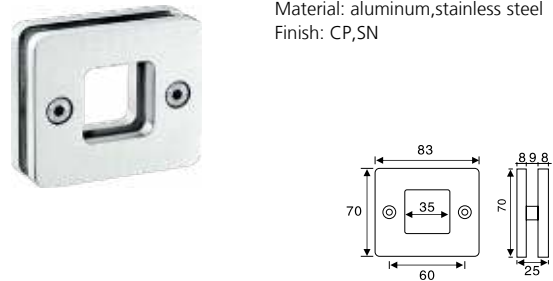

## FT1150

**Bathroom knob**  
Material: aluminum,stainless steel  
Finish: CP,SN

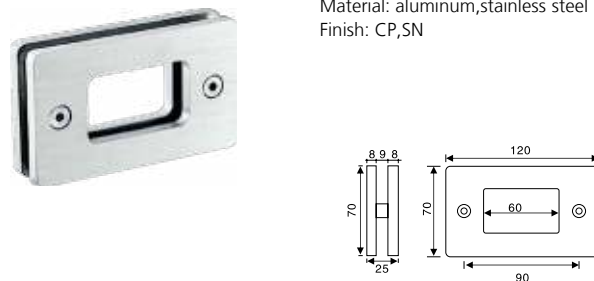

## FT1151

**Bathroom knob**  
Material: Stainless steel  
Finish: CP,SN

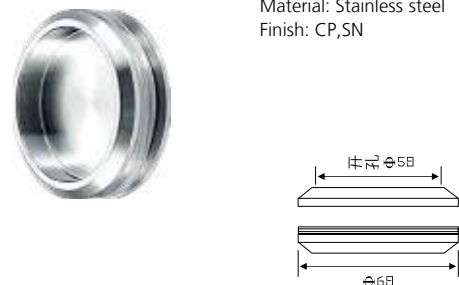

## FT1152

**Bathroom knob**  
Material: Stainless steel  
Finish: CP,SN



## FT1153

**Bathroom knob**  
Material: Stainless steel  
Finish: CP,SN



## FT1154

**Bathroom knob**  
Material: Stainless steel  
Finish: CP,SN



## FT1400

For 6,8,10,12mm glass

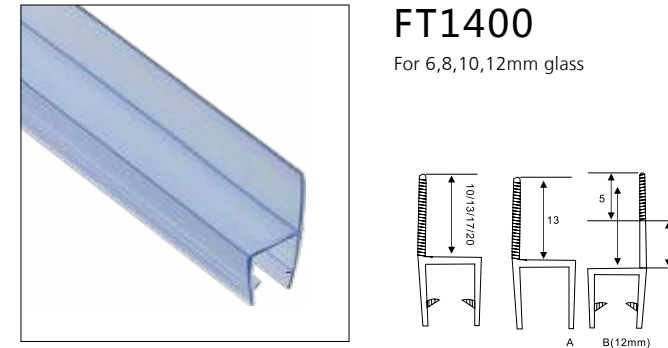

## FT1401

For 6,8,10,12mm glass

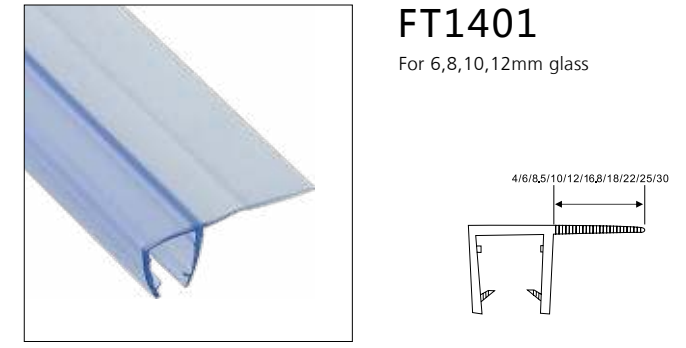

## FT1402

For 6,8,10,12mm glass



## FT1403

For 6,8,10,12mm glass



## FT1404

For 6,8,10,12mm glass

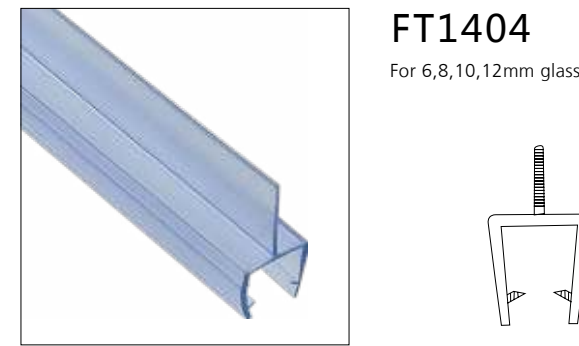

## FT1405

For 6,8,10,12mm glass

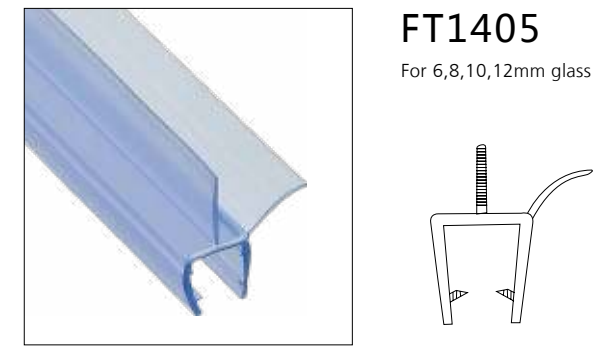

## FT1406

For 6,8,10,12mm glass

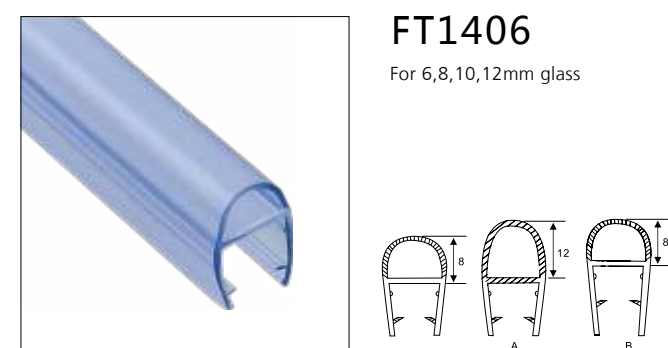

## FT1407

For 6,8,10,12mm glass





**FT1416**

For 6,8,10,12mm glass

**FT1417**

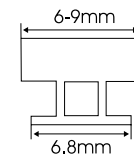
For 6,8,10,12mm glass

**FT1418**

For 6,8,10,12mm glass

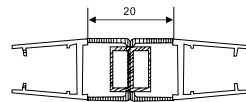
**FT1419**

For 6,8,10,12mm glass

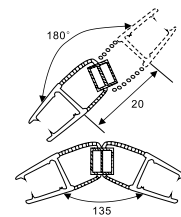
**FT1420**

For 6,8,10,12mm glass

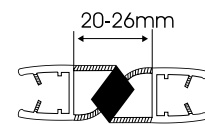
**FT1421**

For 6,8,10,12mm glass

**FT1422**

For 6,8,10,12mm glass

**FT1423**

For 6,8,10,12mm glass

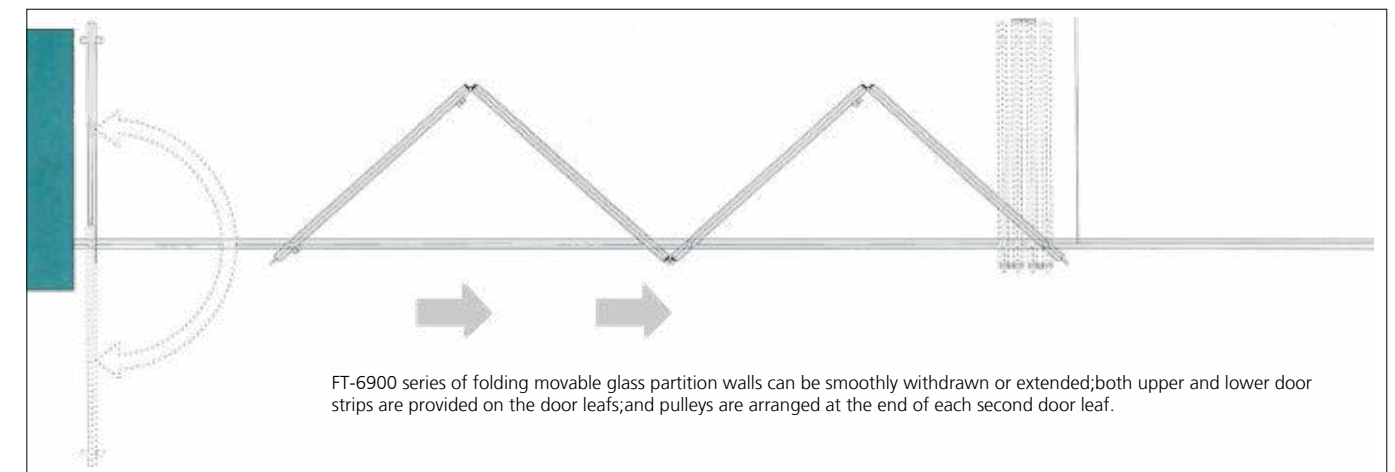
**FT-6900**



## Simple and easy

Folding glass partition panels are of streamlined design without any obstruction therein;in addition,the glass curtain walls are more transparent; both upper and lower door strips are connected into intergrate,to ensure stability and smoothness;easy operation ensures only one person completes the whole partitioning process,satisfactory for the partitioning of various spaces and shops.



## FT-6900





**Structural components for movable glass partition system**

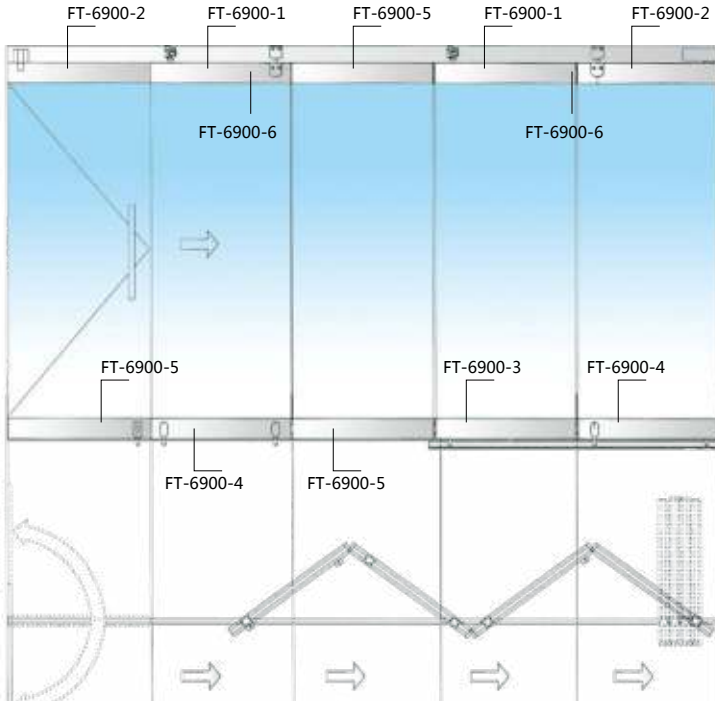

**FT-6900-1**  
Upper door strip(one-side roller)

**FT-6900-2**  
Upper fixing door strip

**FT-6900-3**  
Lower door strip(column)

**FT-6900-4**  
Lower fixing door strip(surface bolt+lower shaft)

**FT-6900-5**  
Upper and lower door strips

**FT-6900-6**  
Lock

**FT-U-6900-2**  
Track

**FT-U-6900-1**  
Track

	End door leaf, equipped with upper and lower fixing door strips, matching floor spring, double-acting type, non-folding.	Folding door leaf, folding door hanging pulley, and bottom bolt.	upper and lower folding door leafs	Folding door leaf, folding door hanging pulley, and bottom bolt.	Beginning door leaf, equipped with upper and lower fixing door strips and bottom bolt.
Max. door leaf height	3000mm	3000mm	3000mm	3000mm	3000mm
Max. door leaf width	1000mm	1000mm	1000mm	1000mm	1000mm
Max. door leaf load	90kg	90kg	90kg	90kg	90kg

## FT-7000

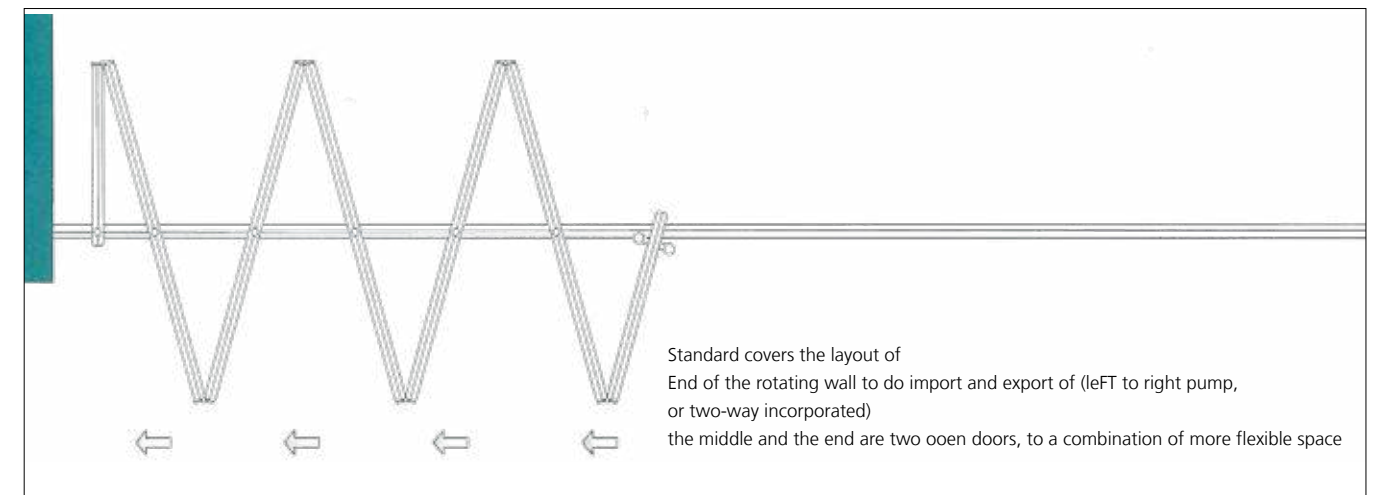

## FT-7000 series of movable glass partitions and functions

FT-7000 series movable glass partition walls enjoy smooth movement, attached with upper and lower door strips. Pulley positions are located in the middle of door leaves. HL-U-999Z series can be used in the large-span partition solutions, and each system can be composed of 3-8 door leaves. Because pulley positions are at the midpoints, paired door leaves are not necessary for this system. Door leaves slide along the fixed tracks which are installed under the ceiling. This partition system does not require additional ground tracks, therefore it will not cause floor damage during arrangement. There must have a beginning door leaf that's connected to folding door leaves. The width of the beginning door leaf is half that of the folding door leaf, and a shaft shall be fitted. Taking into account the symmetry of the overall movable partition, both end and beginning door leaves shall have same width, without pulleys.



### Structural components for movable glass partition system

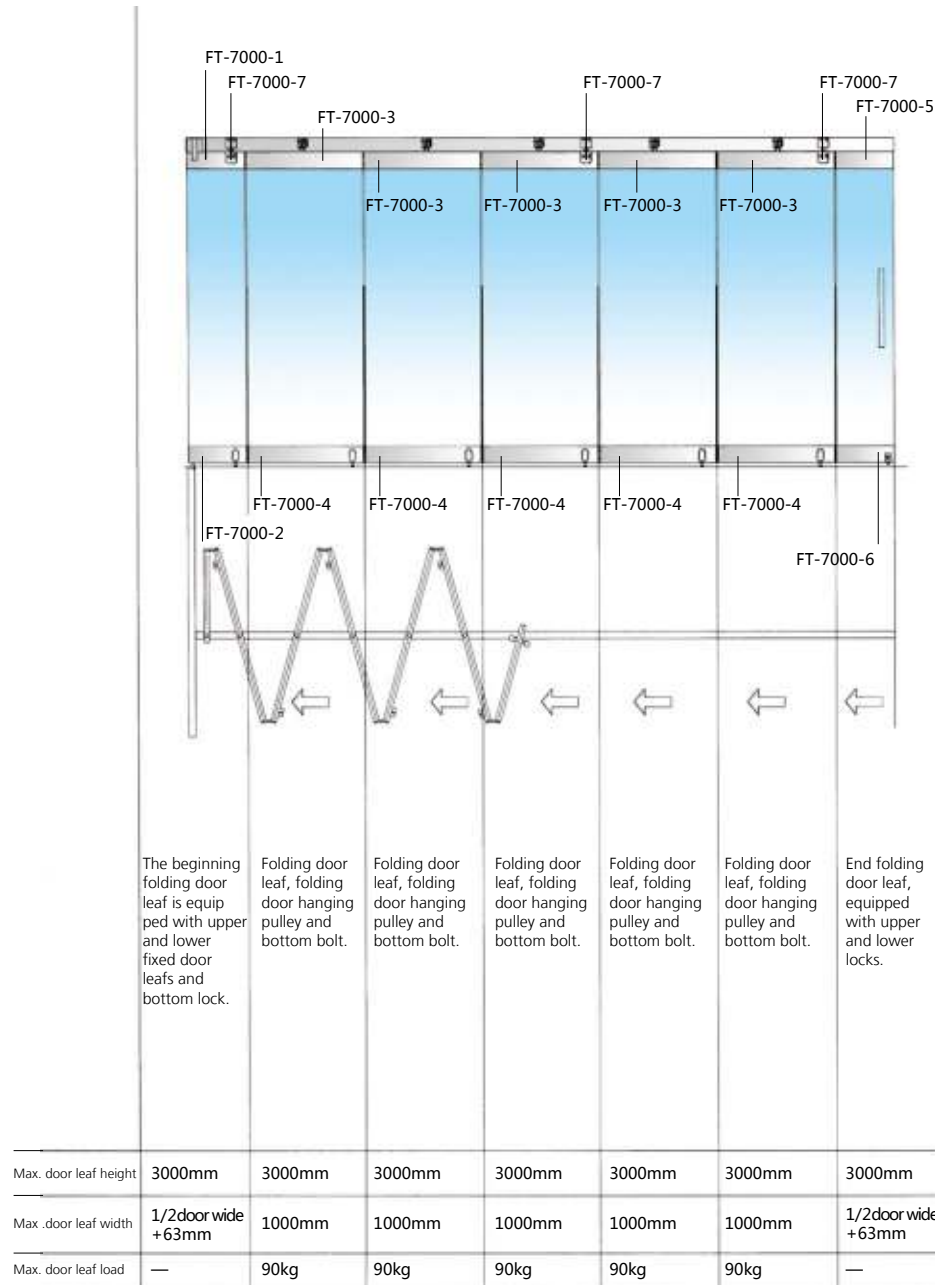

FT-7000-5

Upper end door leaf(1/2 door leaf+63mm)

FT-7000-6

Lower end door leaf(1/2 door leaf+63mm)

FT-7000-7

Lock

FT-U-7000-2

Track

FT-U-7000-1

Track

### Standard Application

- This application is just for reference, will be changed according to the actual scene.



### TECHNOLOGYical date

Daylight opening	Entry width	Door width	Tube length
910-1010mm	800-900mm	880-980mm	2038mm
1010-1110mm	900-1000mm	980-1080mm	2238mm
1110-1210mm	1000-1100mm	1080-1180mm	2438mm
1210-1310mm	1100-1200mm	1180-1280mm	2638mm

### The distance for clamp fixing for track, wall fixing:

- Weight 80kg: max-distance between the clamps=1/2 the width of the door;
- Weight 80kg-120kg: max-distance between the clamps=1/3 the width of the door;
- Weight 120kg-150kg: max-distance between the clamps=1/4 the width of the door.

### Installation

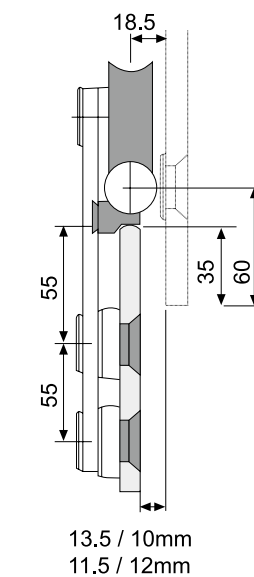

(as required by installation, size &gt; 55MM)

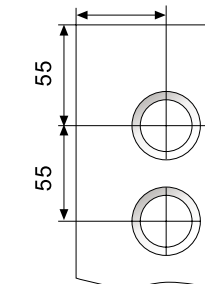

OW = overpanel width  
SW = sidelight width  
DW = door width

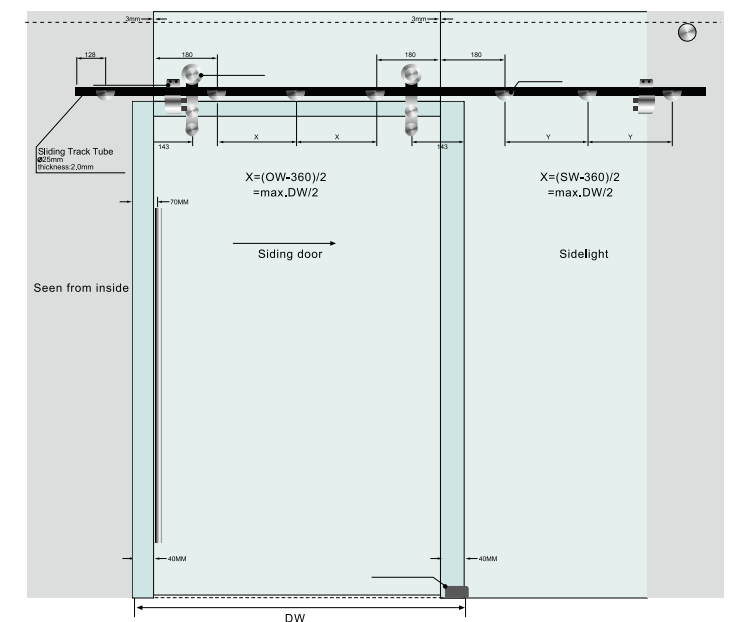



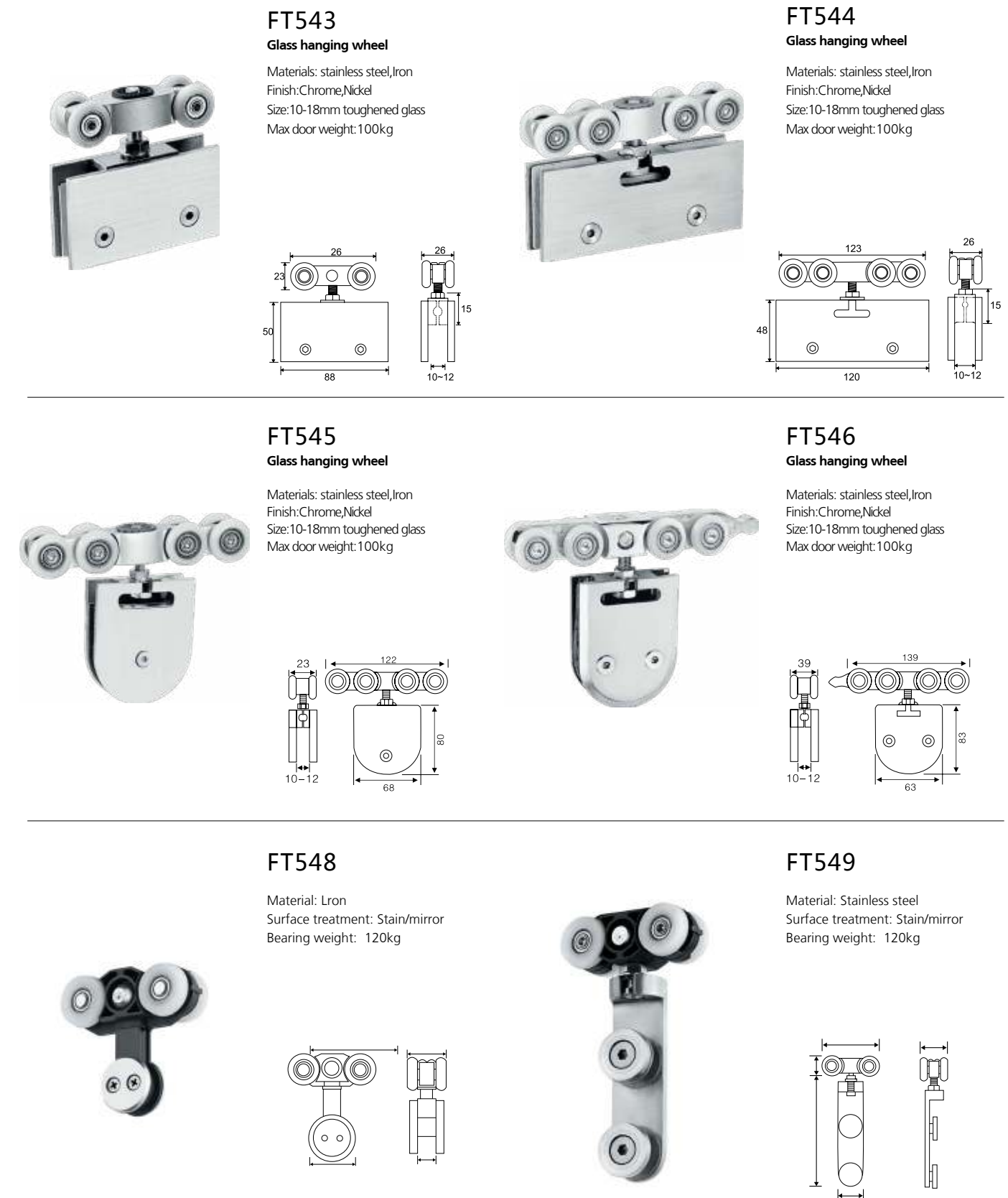



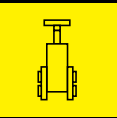

**BALUSTRADE SERIES**

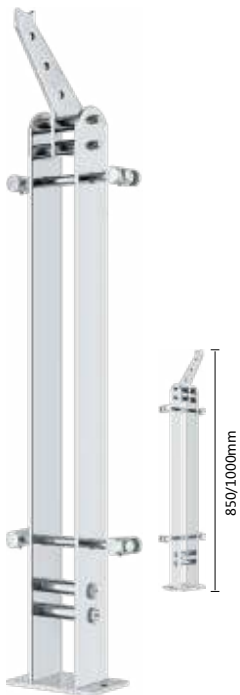

**FT-C-01**

Finish: Satin / Polished

Material: Stainless steel

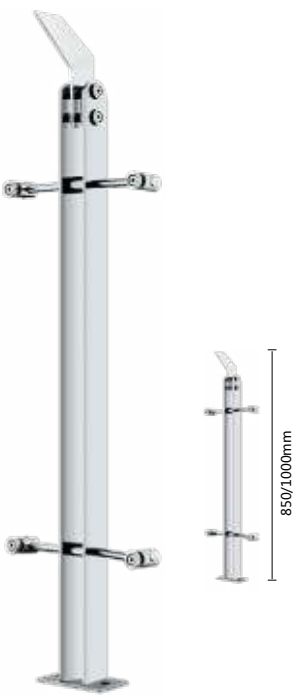

**FT-C-10**

Finish: Satin / Polished

Material: Stainless steel

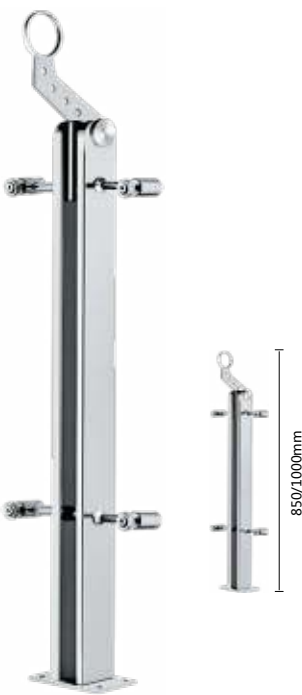

**FT-C-13**

Finish: Satin / Polished

Material: Stainless steel

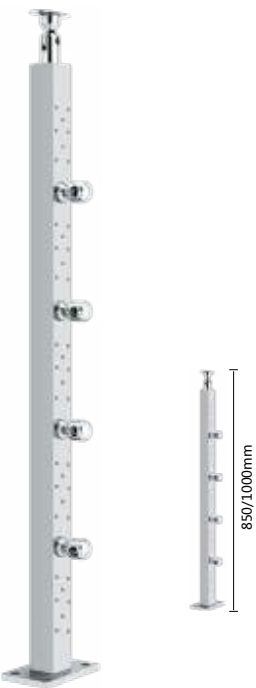

**FT-C-21**

Finish: Satin / Polished

Material: Stainless steel

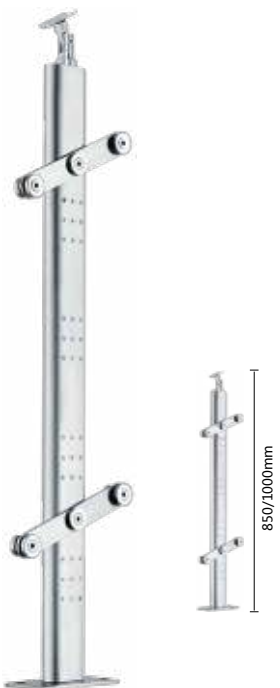

**FT-C-24**

Finish: Satin / Polished

Material: Stainless steel



**FT-C-27**

Finish: Satin / Polished

Material: Stainless steel



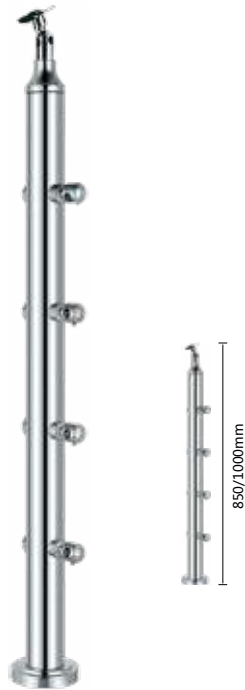

FT-C-29

Finish: Satin / Polished

Material: Stainless steel

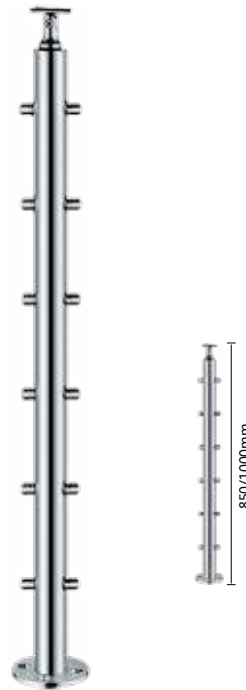

FT-C-31

Finish: Satin / Polished

Material: Stainless steel



FT-C-34

Finish: Satin / Polished

Material: Stainless steel



FT-C-145

Finish: Red bronze

Material: Al-mg alloy+wood



FT-C-42

Finish: Satin / Polished

Material: Stainless steel



FT-C-44

Finish: Satin / Polished

Material: Stainless steel



FT-C-45

Finish: Satin / Polished

Material: Stainless steel



FT-C-147

Finish: Titanium

Material: Stainless steel+wood

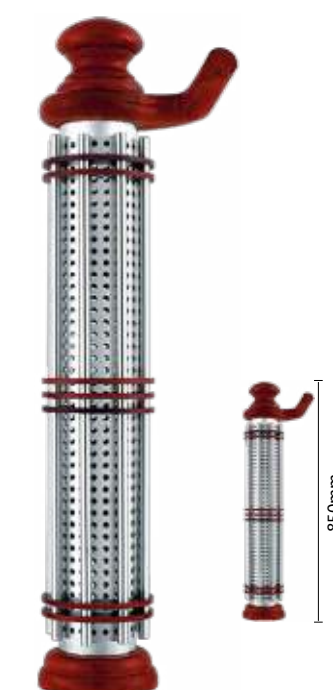

FT-C-148

Finish: Sand-polish

Material: Stainless steel+wood

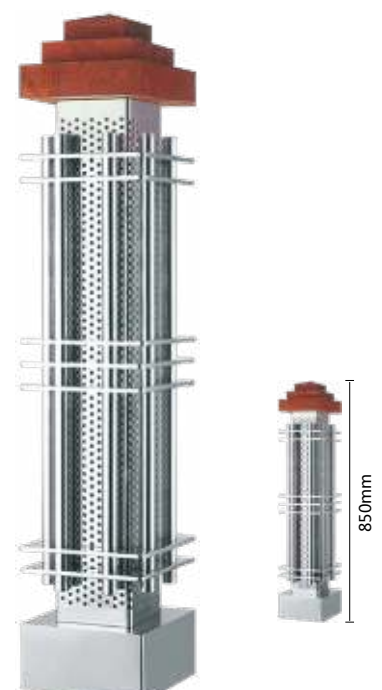

FT-C-149

Finish: Sand-polish

Material: Stainless steel+wood



[illegible]